

Swivel Attachment Fig. AF777

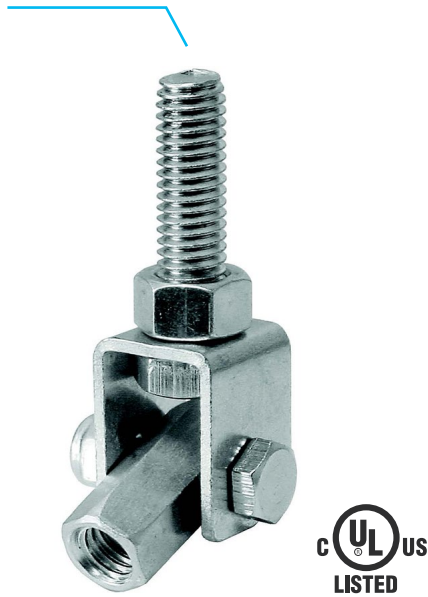

Dimensions (In)

Rod Size	A	B	C	D	E	F
3/8	3	1 3/8	3/4	1 5/8	7/8	3/8
1/2	3 5/8	1 1/2	1 3/16	1 13/16	7/8	1/2

Loads (Lbs) • Dimensions (In)

Service Pipe Size	UL Max Hanger Load (UL 203)	UL Max Seismic Restraint Load (UL 203a)	Max Hanger Load
3/4	Up to 4" Pipe	1,000	250
1/2	Up to 8" Pipe	n/a	760

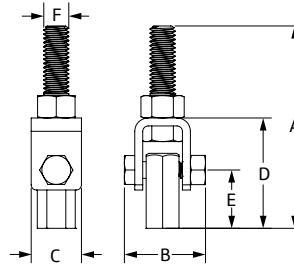

Notes

ASC Engineered Solutions™ brand bracing components are designed to be compatible ONLY with other ASC Engineered Solutions brand bracing components, resulting in a Listed seismic bracing assembly. Updated UL listing information may be viewed at www.ul.com

Disclaimer

ASC Engineered Solutions does not provide any warranties and specifically disclaims any liability whatsoever with respect to ASC Engineered Solutions bracing products and components that are used in combination with products, parts or systems not manufactured or sold by ASC Engineered Solutions. In no event shall ASC Engineered Solutions be liable for any incidental, direct, consequential, special or indirect damages or lost profits where non-ASC Engineered Solutions bracing components have been, or are used.

Material Specifications

Size Range

3/8" through 1/2" rod

Material

Carbon steel

Finish

Electro-Galvanized per ASTM B633

Hanger Service:

Swivel hanger designed to support horizontal piping from angled structures. Listed for installation at angles between 0 and 90 degrees.

Restraint Service

May be installed as a branch line restraint per the requirements of NFPA 13. The AF777 may be installed directly to the structure or to the Fig. AF779.

Approvals

cULus Listed (UL 203 and UL 203a - 3/8" only). Complies with the hanging and restraint requirements listed in NFPA 13.

Installation

- Install mounting bolt into structure or structural attachment and tighten hex nut until the yoke (U-Shaped Bracket) is tight against the structure or attachment.
- Thread the hanger rod or restraint rod into the hex union until it bottoms. Back rod off a maximum of one turn to allow the hex union to swivel freely.
- Adjust angle as necessary.
- If the AF777 is exposed to vibration from the piping system or the structure, jam nuts may be installed on the mounting bolt and the threaded rod.
- Fire Protection applications shall also be installed per NFPA 13 requirements.

Features

Full 90 degree rotation allows for installation at any angle.

Ordering

Specify figure number, finish, size, and description.



PROJECT INFORMATION	APPROVAL STAMP
Project:	Approved
Address:	Approved as noted
Contractor:	Not approved
Engineer:	Remarks:
Submittal Date:	
Notes 1:	
Notes 2:	