



## Climax Metal Products Company

8141 Tyler Boulevard  
Mentor, Ohio 44060  
USA

Toll free: 800-542-6552

Phone: 440-585-0300

Fax: 800-860-5553

Email: [sales@climaxmetal.com](mailto:sales@climaxmetal.com)

Website: [www.climaxmetal.com](http://www.climaxmetal.com)

## ITEM # ISCC-050-037-S, ONE-PIECE, CLAMPING COUPLINGS - ISCC-SERIES

Stainless Steel One-Piece Industry Standard Clamping Coupling. High axial load & torque capacity. Does not mar the shaft.



[Drawing](#) | [Specifications](#) |

### Drawing

### Dimensional Drawing

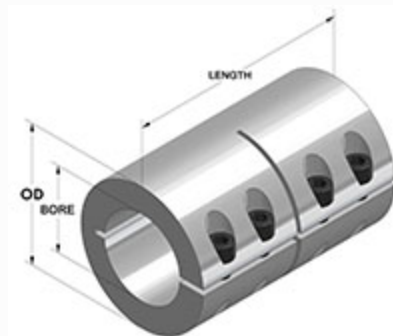

One-Piece Clamping Coupling

### Specifications

<b>Bore</b>	1/2 in
<b>2nd Bore</b>	3/8 in
<b>OD</b>	1 1/8 in
<b>Length</b>	1 3/4 in
<b>Style</b>	One-Piece Clamp
<b>Material</b>	Stainless Steel, ASTM A582
<b>Finish</b>	Plain
<b>Clamp Screw</b>	Hex Socket Cap Screw, 3A Thread, Stainless Steel, ASTM F837: 8-32 x 1/2
<b>Recessed Screw</b>	No
<b>Approximate Weight</b>	6.00 oz
<b>UPC Code</b>	044861431047
<b>Downloads</b>	<a href="#">Catalog Page</a>

### Competitor Part Number

<b>Alternate Part Number</b>	175X10151
	2336675
	2AMG1
	4171642
	5495699
	61005K644
	70545009
	75008006
	CC-704
	CLX86SS
	CLX-8-6-SS