

# SHAFT LOCKNUTS

785-392-3017 FAX 785.392.2845

REVISED 09-04  
www.huyett.com

AVAILABLE IN STAINLESS STEEL

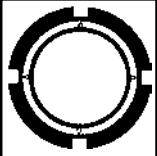
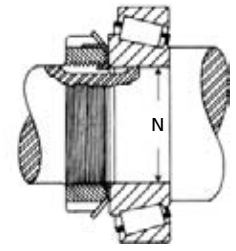
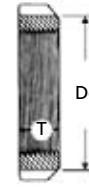
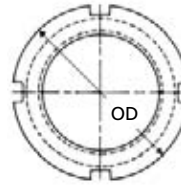

## STANDARD

### MANUFACTURER CROSS-REFERENCE

INDEX  
PAGE 236

Standard Locknut	N/AN
Whittet-Higgins	N/AN

N AN	BORE		Threads per Inch	LOCKNUT DIMENSIONS				WEIGHT Lbs. per 100 Pieces	MATERIAL		Mating Lockwasher	
	Bearing Bore Nominal (N) Decimal	MM		Outside Dia. (OD) +.005/-015	Thickness (T) Min. Max.		Nut Face Diameter (Dc) Min. Max.		Low Carbon	Stainless (NS-)		
N-00	.3937	10	32	3/4	.209	.229	.605	.625	1.2500			W-00
-01	.4724	12		7/8	.303	.323	.699	.719	3.1250			-01
-02	.5906	15		1	.303	.323	.793	.813	3.7500			-02
-03	.6693	17		1-1/8	.334	.354	.918	.938	5.6250			-03
-04	.7874	20		1-3/8	.365	.385	1.105	1.125	8.7500			-04
-05	.9843	25		1-9/16	.396	.416	1.261	1.281	11.2500			-05
-06	1.1811	30		1-3/4	.396	.416	1.480	1.500	13.7500			W-06
-065	1.3125	33-1/3		2-1/16	.428	.448	1.793	1.813	22.5000			WH-065
-07	1.3780	35		2-1/16	.428	.448	1.793	1.813	20.0000			W-07
-08	1.5748	40		2-1/4	.428	.448	1.980	2.000	23.1250			-08
-09	1.7717	45		2-17/32	.428	.448	2.261	2.281	28.7500			-09
-10	1.9685	50		2-11/16	.490	.510	2.418	2.438	33.7500			-10
-11	2.1654	55		2-31/32	.490	.510	2.636	2.656	41.2500			-11
-12	2.3622	60	3-5/32	.521	.541	2.824	2.844	46.8750			-12	
-13	2.5591	65	3-3/8	.553	.573	3.043	3.063	53.7500			-13	
N-14	2.7559	70	3-5/8	.553	.573	3.283	3.313	62.5000			-14	
AN-15	2.9528	75	3-7/8	.584	.604	3.533	3.563	77.5000			-15	
-16	3.1496	80	4-5/32	.584	.604	3.814	3.844	92.5000			-16	
-17	3.3465	85	4-13/32	.615	.635	4.001	4.031	105.0000			-17	
-18	3.5433	90	4-21/32	.678	.698	4.251	4.281	130.0000			-18	
-19	3.7402	95	4-15/16	.709	.729	4.533	4.563	155.0000			-19	
-20	3.9370	100	5-3/16	.735	.760	4.783	4.813	181.2500			-20	
-21	4.1339	105	5-7/16	.735	.760	4.970	5.000	190.0000			-21	
-22	4.3307	110	5-23/32	.766	.791	5.251	5.281	223.7500			-22	
-24	4.7244	120	6-1/8	.798	.823	5.658	5.688	260.0000			-24	
-26	5.1181	130	6-3/4	.860	.885	6.158	6.188	350.0000			-26	
-28	5.5118	140	7-3/32	.923	.948	6.501	6.531	387.5000			-28	
-30	5.9055	150	7-11/16	.954	.979	7.033	7.063	487.5000			-30	
-32	6.2992	160	8-1/16	1.016	1.041	7.398	7.438	550.0000			-32	
-34	6.6929	170	8-21/32	1.048	1.073	7.991	8.031	687.5000			-34	
-36	7.0866	180	9-1/16	1.079	1.104	8.335	8.375	725.0000			-36	
-38	7.4803	190	9-15/32	1.110	1.135	8.741	8.781	787.5000			-38	
AN-40	7.8740	200	9-27/32	1.173	1.198	9.116	9.156	868.7500			-40	
N-44	8.6614	220	11	1.230	1.260	9.803	9.841	1175.0000			W-44	

MATING LOCKWASHER DESCRIPTIONS ON PAGE 141

<h1>N AN</h1>	<b>DESCRIPTION</b>	<b>HOW TO IDENTIFY</b>	<b>GENERAL USE</b>	<b>REQUIRES A KEYWAY.</b>    <b>LET OUR SHOP CUT IT FOR YOU!</b>
	Most commonly used locknuts. Require a lockwasher and keyway in the shaft. "AN" series were for an old specification (11 threads per inch) and should be avoided.	1. Confirm the outside diameter (OD) of the part. 2. Measure the thickness (T) of the part. 3. Verify the nut face diameter (Dc). 4. Find the part in the chart above.	 COMMON	
<b>AXIAL ASSEMBLY</b>				
<b>FOR TAPERED ROLLER BEARINGS IT IS BEST TO USE OUR HIGHER PRECISION "PN" SERIES (SEE PAGE 137).</b>				

SEE PAGE 140.



**MOST SIZES AVAILABLE IMMEDIATELY • \$2 LINE REQUESTED • CALL PLANT FOR QUANTITY DISCOUNTS**