

# SHAFT LOCKNUTS

785-392-3017 FAX 785.392.2845

REVISED 09-04  
www.huyett.com

AVAILABLE IN STAINLESS STEEL

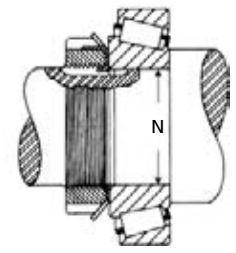
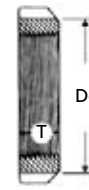
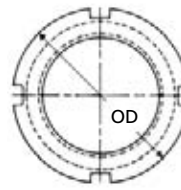

## STANDARD

### MANUFACTURER CROSS-REFERENCE

INDEX  
PAGE 236

Standard Locknut	N/AN
Whittet-Higgins	N/AN

N AN	BORE		Threads per Inch	LOCKNUT DIMENSIONS				WEIGHT Lbs. per 100 Pieces	MATERIAL		Mating Lockwasher	
	Bearing Bore Nominal (N) Decimal	MM		Outside Dia. (OD) +.005/-015	Thickness (T) Min. Max.		Nut Face Diameter (Dc) Min. Max.		Low Carbon	Stainless (NS-)		
N-00	.3937	10	32	3/4	.209	.229	.605	.625	1.2500			W-00
-01	.4724	12		7/8	.303	.323	.699	.719	3.1250			-01
-02	.5906	15		1	.303	.323	.793	.813	3.7500			-02
-03	.6693	17		1-1/8	.334	.354	.918	.938	5.6250			-03
-04	.7874	20		1-3/8	.365	.385	1.105	1.125	8.7500			-04
-05	.9843	25		1-9/16	.396	.416	1.261	1.281	11.2500			-05
-06	1.1811	30		1-3/4	.396	.416	1.480	1.500	13.7500			W-06
-065	1.3125	33-1/3		2-1/16	.428	.448	1.793	1.813	22.5000			WH-065
-07	1.3780	35		2-1/16	.428	.448	1.793	1.813	20.0000			W-07
-08	1.5748	40		2-1/4	.428	.448	1.980	2.000	23.1250			-08
-09	1.7717	45		2-17/32	.428	.448	2.261	2.281	28.7500			-09
-10	1.9685	50		2-11/16	.490	.510	2.418	2.438	33.7500			-10
-11	2.1654	55		2-31/32	.490	.510	2.636	2.656	41.2500			-11
-12	2.3622	60	3-5/32	.521	.541	2.824	2.844	46.8750			-12	
-13	2.5591	65	3-3/8	.553	.573	3.043	3.063	53.7500			-13	
N-14	2.7559	70	3-5/8	.553	.573	3.283	3.313	62.5000			-14	
AN-15	2.9528	75	3-7/8	.584	.604	3.533	3.563	77.5000			-15	
-16	3.1496	80	4-5/32	.584	.604	3.814	3.844	92.5000			-16	
-17	3.3465	85	4-13/32	.615	.635	4.001	4.031	105.0000			-17	
-18	3.5433	90	4-21/32	.678	.698	4.251	4.281	130.0000			-18	
-19	3.7402	95	4-15/16	.709	.729	4.533	4.563	155.0000			-19	
-20	3.9370	100	5-3/16	.735	.760	4.783	4.813	181.2500			-20	
-21	4.1339	105	5-7/16	.735	.760	4.970	5.000	190.0000			-21	
-22	4.3307	110	5-23/32	.766	.791	5.251	5.281	223.7500			-22	
-24	4.7244	120	6-1/8	.798	.823	5.658	5.688	260.0000			-24	
-26	5.1181	130	6-3/4	.860	.885	6.158	6.188	350.0000			-26	
-28	5.5118	140	7-3/32	.923	.948	6.501	6.531	387.5000			-28	
-30	5.9055	150	7-11/16	.954	.979	7.033	7.063	487.5000			-30	
-32	6.2992	160	8-1/16	1.016	1.041	7.398	7.438	550.0000			-32	
-34	6.6929	170	8-21/32	1.048	1.073	7.991	8.031	687.5000			-34	
-36	7.0866	180	9-1/16	1.079	1.104	8.335	8.375	725.0000			-36	
-38	7.4803	190	9-15/32	1.110	1.135	8.741	8.781	787.5000			-38	
AN-40	7.8740	200	9-27/32	1.173	1.198	9.116	9.156	868.7500			-40	
N-44	8.6614	220	11	1.230	1.260	9.803	9.841	1175.0000			W-44	

MATING LOCKWASHER DESCRIPTIONS ON PAGE 141

<h1>N AN</h1>	<b>DESCRIPTION</b>	<b>HOW TO IDENTIFY</b>	<b>GENERAL USE</b>	<p><b>REQUIRES A KEYWAY.</b></p> <p><b>LET OUR SHOP CUT IT FOR YOU!</b></p>
	<p>Most commonly used locknuts. Require a lockwasher and keyway in the shaft. "AN" series were for an old specification (11 threads per inch) and should be avoided.</p> <p style="text-align: center;"><b>AXIAL ASSEMBLY</b></p>	<ol style="list-style-type: none"> <li>1. Confirm the outside diameter (OD) of the part.</li> <li>2. Measure the thickness (T) of the part.</li> <li>3. Verify the nut face diameter (Dc).</li> <li>4. Find the part in the chart above.</li> </ol>	<p><b>COMMON</b></p>	
<p><b>FOR TAPERED ROLLER BEARINGS IT IS BEST TO USE OUR HIGHER PRECISION "PN" SERIES (SEE PAGE 137).</b></p>				<p>SEE PAGE 140.</p>



**MOST SIZES AVAILABLE IMMEDIATELY • \$2 LINE REQUESTED • CALL PLANT FOR QUANTITY DISCOUNTS**