

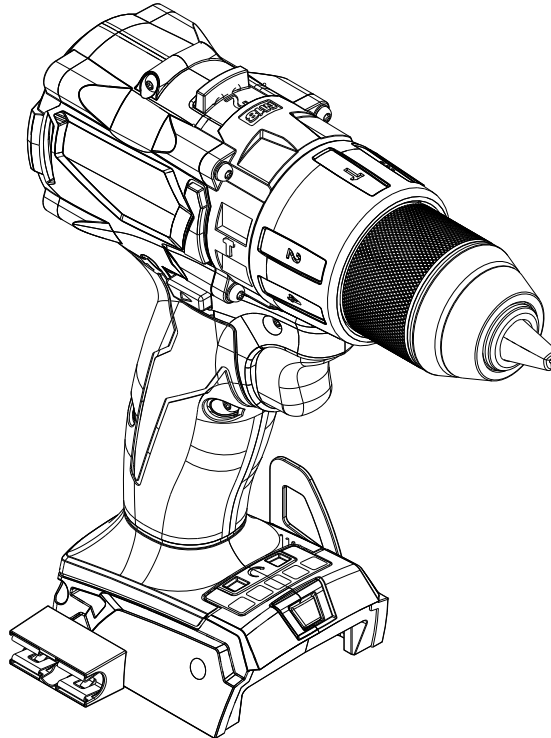

SERVICE PARTS LIST

BULLETIN NO.
54-00-2806

SPECIFY CATALOG NO. AND SERIAL NO. WHEN ORDERING PARTS		REVISED BULLETIN	DATE
M18™ FUEL™ ONE KEY HAMMER-DRILL			Aug 2021
CATALOG NO.	2806-20	STARTING SERIAL NO.	J79A & J79B
WIRING INSTRUCTION			



Service for Milwaukee Tool ONE KEY Products
can only be performed at this
Milwaukee factory Central Repair Center:

MILWAUKEE TOOL Central Repair
1401 Sycamore Avenue • Greenwood, MS 38930-7277

Please send your tool directly to this location for service.

Or

Via e-Service at: www.milwaukeetool.com/e-service
questions, please call 1.800.SAWDUST (1.800.729.3878)

Or

Return it to a MILWAUKEE *factory* Service Center location, freight prepaid and insured.
A copy of the proof of purchase should be included with the return product.

If you have questions please contact Milwaukee Product Service at:

Product Technical Support via phone at: 262.783.8642

Or

Via email at: METProductSupport@milwaukeetool.com

Disassembly is not recommended and could void the warranty.

