

► CAD insertion point

Female: **M** D-2 **H** Core: 58-62 HRC, Surface: 80 HRC **S** Titanium Nitride Coated

Male: **M** H-13 **H** 42-48 HRC **S** Salt Bath Nitrided

**METRIC STANDARD**

Note: All dimensions and tolerances are in millimeters.

CATALOG NUMBER	T +0.00 -0.05	W +0.00 -0.01	A +0.00 -0.05	B +0.00 -0.05	C	D .002/.005 Clearance Per Side	S1 ±.25	S2 ±.25	R Pocket Radius	Z Chamfer	SHCS	
TLM26X35	26	35	25	15	17	11	13	23	8	1	M: M5 x 16	F: M5 x 25
TLM30X45	30	45	25	15	17	15	15	30	8	1	M: M6 x 18	F: M6 x 25
TLM36X55	36	55	30	20	21.5	20	18	37.5	8	1	M: M8 x 22	F: M8 x 35
TLM36X75	36	75	35	20	26	30	18	52	8	1.5	M: M10 x 25	F: M10 x 35
TLM45X100	45	100	60	20	42	40	22.5	70	8	1.5	M: M10 x 25	F: M10 x 65

Screws included.

 For custom Locks, refer to the templates in section X.

**Additional Option:**

Top Locks are also available with dual radii for mounting internally. To order, specify the catalog number followed by "-R".  
Ex. TL112X200-R.

Shuttle sets are also available in both the standard top locks and the dual radii option.

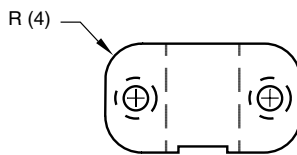

**Lubrication:**

- For packaging and storage lubrication, Setral food grade grease is applied to all areas, including the particle rings.
- For production, install the locks and wipe down the outside of the Top Locks only; maintain the grease on the mating surfaces and within the rings.

Patents pending