

The Best Products, The Best Service...

SERVICE METAL

ONE CALL GETS IT ALL



Weld Neck Flange CLASS 150 Inches / Pounds

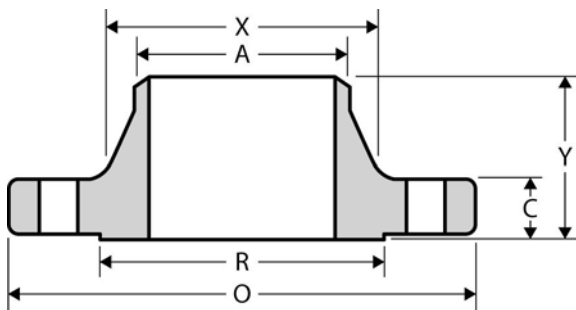

| Nominal Pipe Size | Outside Diam. of Flange (O) | Thick. of Flange (C) | Diam. of Raised Face (R) | Diam. of Hub at Base (X) | Diam. of Hub at Point of Welding (A) | Length thru Hub (Y) | No. of Holes | Diam. of Holes | Diam. of Bolts | Diam. of Bolt Circle | Approx. Weight (in Pounds) |
|-------------------|-----------------------------|----------------------|--------------------------|--------------------------|--------------------------------------|---------------------|--------------|----------------|----------------|----------------------|----------------------------|
| ½ | 3.50 | 0.44 | 1.38 | 1.19 | 0.84 | 1.88 | 4 | 0.62 | 0.50 | 2.38 | 2 |
| ¾ | 3.88 | 0.50 | 1.69 | 1.50 | 1.05 | 2.06 | 4 | 0.62 | 0.50 | 2.75 | 2 |
| 1 | 4.25 | 0.56 | 2.00 | 1.94 | 1.32 | 2.19 | 4 | 0.62 | 0.50 | 3.12 | 3 |
| 1 ¼ | 4.62 | 0.62 | 2.50 | 2.31 | 1.66 | 2.25 | 4 | 0.62 | 0.50 | 3.50 | 3 |
| 1 ½ | 5.00 | 0.69 | 2.88 | 2.56 | 1.90 | 2.44 | 4 | 0.62 | 0.50 | 3.88 | 4 |
| 2 | 6.00 | 0.75 | 3.62 | 3.06 | 2.38 | 2.50 | 4 | 0.75 | 0.62 | 4.75 | 6 |
| 2 ½ | 7.00 | 0.88 | 4.12 | 3.56 | 2.88 | 2.75 | 4 | 0.75 | 0.62 | 5.50 | 8 |
| 3 | 7.50 | 0.94 | 5.00 | 4.25 | 3.50 | 2.75 | 4 | 0.75 | 0.62 | 6.00 | 10 |
| 3 ½ | 8.50 | 0.94 | 5.50 | 4.81 | 4.00 | 2.81 | 8 | 0.75 | 0.62 | 7.00 | 12 |
| 4 | 9.00 | 0.94 | 6.19 | 5.31 | 4.50 | 3.00 | 8 | 0.75 | 0.62 | 7.50 | 15 |
| 5 | 10.00 | 0.94 | 7.31 | 6.44 | 5.56 | 3.50 | 8 | 0.88 | 0.75 | 8.50 | 19 |
| 6 | 11.00 | 1.00 | 8.50 | 7.56 | 6.63 | 3.50 | 8 | 0.88 | 0.75 | 9.50 | 24 |
| 8 | 13.50 | 1.12 | 10.62 | 9.69 | 8.63 | 4.00 | 8 | 0.88 | 0.75 | 11.75 | 39 |
| 10 | 16.00 | 1.19 | 12.75 | 12.00 | 10.75 | 4.00 | 12 | 1.00 | 0.88 | 14.25 | 52 |
| 12 | 19.00 | 1.25 | 15.00 | 14.38 | 12.75 | 4.50 | 12 | 1.00 | 0.88 | 17.00 | 80 |
| 14 | 21.00 | 1.38 | 16.25 | 15.75 | 14.00 | 5.00 | 12 | 1.12 | 1.00 | 18.75 | 110 |
| 16 | 23.50 | 1.44 | 18.50 | 18.00 | 16.00 | 5.00 | 16 | 1.12 | 1.00 | 21.25 | 140 |
| 18 | 25.00 | 1.56 | 21.00 | 19.88 | 18.00 | 5.50 | 16 | 1.25 | 1.12 | 22.75 | 150 |
| 20 | 27.50 | 1.69 | 23.00 | 22.00 | 20.00 | 5.69 | 20 | 1.25 | 1.12 | 25.00 | 180 |
| 24 | 32.00 | 1.88 | 27.25 | 26.12 | 24.00 | 6.00 | 20 | 1.38 | 1.25 | 29.50 | 260 |

* Dimensions conform to ASTM A/SA-105; ANSI B16.5

* Bore to be determined at time of order.