



2018

PRODUCT CATALOG

1.800.447.3150 | www.hillsdaleterminal.com

HT

Hillsdale
Terminal

Table of Contents

- 3 and 4 Way Connectors 22
- Accessories 36
- Adapters 26
- Battery Cables 29
- Battery Covers 29
- Battery Terminals 28
- Brazed Seam Terminals 15
- Bullet Connectors 21
- Butt Connectors 3-5
- Cable Ties & Accessories 30
- Clips, Split Loom & Spiral Wraps 35
- Closed End Connectors 17
- Ferrule Wire Ends 26
- Flags 23
- Fuses, Fuse Holders 34
- Fuse Pullers 34
- Heat Shrink Terminals 24
- Heat Shrink Tubing 25
- Heavy Duty Electrical Lugs 27
- High Temp. Terminals 16
- Hooks 14
- IDC & Miscellaneous 33
- Instant Tap Connectors 33
- Kits 42-43
- Mylar Tape Products 41
- Parallel Connectors 26
- Piggybacks 17
- Pin Terminals 23
- Quick Disconnects 18-20
- Rings 6-9
- Screw On Connectors 32
- Spades 10-13
- Tape 40
- Tools 36-39
- T-Tap Connectors 33
- Wire 31
- Wire Processing 41
- Wrap 40

About Hillsdale Terminal

HILLSDALE TERMINAL is proud of our 40 years of continuous service to the industry. The now 3rd generation Company was started back in 1976 by the founder, Harry F. Condon. We are confident that you will find our quality, service, and delivery to be the very best.

There are three locations in Michigan. The 35,000 Sq. Ft. manufacturing plant is where all the stamping and production is being done. Just down the road, a short distance is the 24,000 Sq. Ft. Hillsdale plant. This building houses our sales and administrative offices as well as our shipping and packaging departments. Just around the corner, is our new 12,500 Sq. Ft. molding facility. This building houses all the injection molding and extruder processing. It also offers additional storage for material and stock.

Please contact a Hillsdale representative to discuss your needs or for additional information about our products and services.

Terminal Terminology

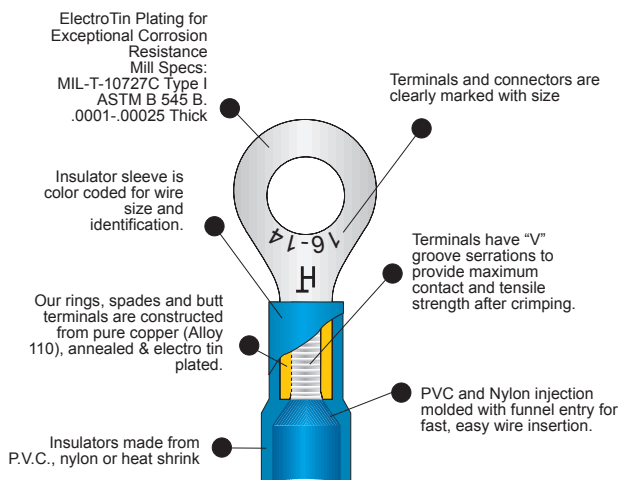

Recognizing Terminal Types

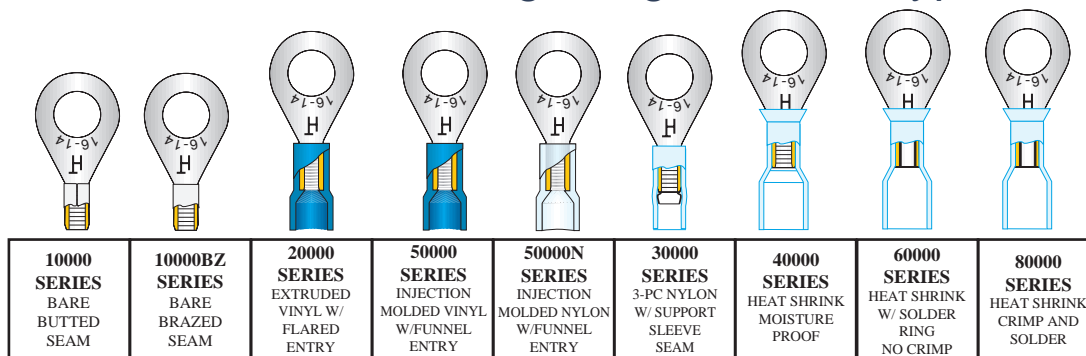

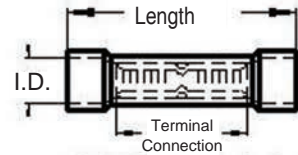
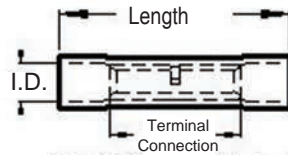
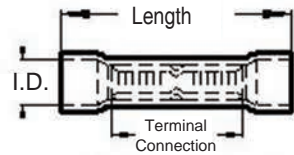
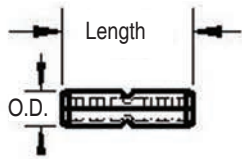

L = Length

M = Material Thickness

Vinyl Insulated Butted Seam Butt Connector Shown

Extruded Nylon Insulated Seamless or Butted Seam Butt Connector

Molded Nylon Insulated Seamless or Butted Seam Butt Connector

Bare Butted Seam

Wire Size	Part Number	L	O.D.	M
22-18	10080*	.560	.133/.135	.028
	10080E	.560	.112/.115	.020

16-14	10170*	.560	.152/.156	.030
	10170E	.560	.134/.135	.020

12-10	10310*	.625	.212/.215	.035
	10310E	.625	.208/.210	.030

Bare Seamless

26-24	12403	.475	.084	.018
-------	-------	------	------	------

22-18	10083	.565	.133/.135	.030
	10083L	.625	.133/.135	.030

16-14	10173	.565	.152/.156	.030
	10173L	.630	.152/.156	.030

12-10	10313	.625	.212/.215	.035
	10313L	.810	.212/.215	.035

8	10624	.827	.273/.275	.049
---	-------	------	-----------	------

6	10625	1.030	.350/.352	.058
---	-------	-------	-----------	------

4	10626	1.140	.438/.440	.070
---	-------	-------	-----------	------

2	10627	1.250	.512/.514	.072
---	-------	-------	-----------	------

Vinyl Insulated

Wire Size	Part Number	L	Terminal	I.D.
22-18	20080*	.970	10080	.160
	20080E	.970	10080E	.160

16-14	20170*	.970	10170	.180
	20170E	.970	10170E	.180

12-10	20310*	1.060	10310	.235
	20310E	1.060	10310E	.235

8	20624	1.460	10624	.320
---	-------	-------	-------	------

6	20625	1.740	10625	.395
---	-------	-------	-------	------

4	20626	1.930	10626	.500
---	-------	-------	-------	------

2	20627	2.250	10627	.560
---	-------	-------	-------	------

Vinyl - Seamless

22-18	20080SV	.970	10083	.160
-------	---------	------	-------	------

16-14	20170SV	.970	10173	.185
-------	---------	------	-------	------

12-10	20310SV	1.060	10313	.235
-------	---------	-------	-------	------

Nylon - Butted Seam Straight

Wire Size	Part Number	L	Terminal	I.D.
22-18	20081 20081E	.990 .990	10080 10080E	.135 .135
16-14	20171 20171E	.990 .990	10170 10170E	.155 .155
12-10	20311 20311E	1.070 1.070	10310 10310E	.205 .205

Nylon - Butted Seam Flared

22-18	50081 50081E	.985 .985	10080 10083L	.165 .165
16-14	50171 50171E	.985 .985	10170 10173L	.195 .195
12-10	50311 50311E	1.070 1.070	10310 10313L	.270 .270

Nylon - Seamless Flared

22-18	20083	.985	10083	.165
16-14	20173	.985	10173	.195
12-10	20313	1.070	10313	.270

Nylon - Seamless Straight

Wire Size	Part Number	L	Terminal	I.D.
26-24	22403	.757	12403	.080
22-18	20083S 20083LN	.990 1.06	10083 10083L	.135 .135
16-14	20173S 20173LN	.990 1.06	10173 10173L	.155 .155
12-10	20313S 20313LN	1.070 1.25	10313 10313L	.205 .205

8	20624N	1.500	10624	.260
6	20625N	1.780	10625	.340
4	20626N	1.980	10626	.430

4 Pc Nylon w/ Sleeve

22-18	30080	1.00	10080	.135
16-14	30170	1.00	10170	.155
12-10	30310	1.20	10310	.205

Step Down Butts

Bare Seamless Step Down Butts

Wire Size	Part Number	Insulation Color & Stripe
26-24 to 22-18	10315	w/26-24 white & 22-18 red stripe
16-14 to 22-18	10316	w/22-18 red & 16-14 blue stripe
12-10 to 16-14	10317	w/16-14 blue & 12-10 yellow stripe
8 to 12-10	10318	w/12-10 yellow & red 8 ga stripe
6 to 8	10319	w/ 6 ga blue & 8 ga red stripe
12-10 to 22-18	10320	w/ 12-10 yellow & 22-18 red stripe
8 to 16-14	10321	w/ 8 ga red & 16-14 blue stripe

Vinyl Step Down

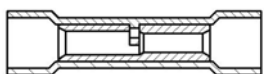

22-18 to 26-24	20315	red w/22-18 & 26-24 white stripe
16-14 to 22-18	20316	blue w/22-18 red & 16-14 blue stripe
12-10 to 16-14	20317	yellow w/16-14 blue & 12-10 yellow stripe
8 to 12-10	20318	red w/12-10 yellow & red 8 ga stripe
6 to 8	20319	blue w/ red stripe
12-10 to 22-18	20320	yellow w/ red 12-10 / 22-18 ga
8 to 16-14	20321	red w/ blue 8 ga / 16-14 ga

Heat Shrink Step Down

22-18 to 26-24	40315	red w/ 26-24 & 22-18 white stripe
16-14 to 22-18	40316	blue w/22-18 red & 16-14 blue stripe
12-10 to 16-14	40317	yellow w/16-14 blue & 12-10 yellow stripe
8 to 12-10	40318	red w/ 12-10 yellow & red 8 ga stripe

Heat Shrink Step Down - NYAX

NEW

16-14 to 22-18	70316	blue w/22-18 red & 16-14 blue stripe
12-10 to 16-14	70317	yellow w/16-14 blue & 12-10 yellow stripe

Vinyl - Oval Butt

Wire Size	Part Number	L	Terminal	I.D.
16-14	20174	.960	10170	.180



Nylon - Moisture Resistant

22-18	30080G	1.04	-	.145
16-14	30170G	1.04	-	.170
12-10	30310G	1.25	-	.250



Heat Shrink Over Nylon

22-18	42083	1.800	20083S	.180
16-14	42173	1.800	20173S	.250
12-10	42313	2.000	20313S	.325



Heat Shrink - Polyolefin

26-22	40024	1.00		.125
22-18	20082 20082L	1.500 1.500	10083 10083L	.165 .165
16-14	20172 20172L	1.500 1.500	10173 10173L	.196 .196
12-10	20312	1.700	10313L	.250
8	40624	1.800	10624	.312
6	40625		* Sold Unassembled (Part# 10625 & 284)	



Heat Shrink - NYAX

22-18	40082 40082L	1.250 1.500	10083 10083L	.200 .200
16-14	40172 40172L	1.250 1.500	10173 10173L	.250 .250
12-10	40312 40312L	1.500 1.750	10313 10313L	.280 .280



Bare Butted Seam

Wire Size	Stud Size	Part Number
	4	10014
	6	10020*
	6 .187 Barrel	10020E
	6 Slim	10021
	6 Slim .187 Barrel	10021E
	8	10030*
	8 Slim	10038
22-18	8 Slim .187 Barrel	10038E
	10	10040*
	10 .187 Barrel	10040E
	1/4	10041*
	1/4 Slim	10044*
	1/4 Slim .187 Barrel	10044E
	5/16	10042*
	5/16 .187 Barrel	10042E
	3/8	10043*



Bare Brazed Seam (cont.)

Wire Size	Stud Size	Part Number
	4	10014BZ
	6	10020BZ*
	6 .187 Barrel	10020EBZ
	6 Slim	10021BZ
	6 Slim .187 Barrel	10021EBZ
	8	10030BZ*
	8 Slim	10038BZ
22-18	8 Slim .187 Barrel	10038EBZ
	10	10040BZ*
	10 .187 Barrel	10040EBZ
	1/4	10041BZ*
	1/4 Slim	10044BZ*
	1/4 Slim .187 Barrel	10044EBZ
	5/16	10042BZ*
	5/16 .187 Barrel	10042EBZ
	3/8	10043BZ*



16-14

	4	10084
	6	10086*
	6 .187 Barrel	10086E
	6 Slim	10085
	8	10090*
	8 Slim	10098
	8 Slim .187 Barrel	10098E
	10	10100*
	10 .187 Barrel	10100E
	1/4	10101*
	1/4 Slim	10114*
	1/4 Slim .187 Barrel	10114E
	5/16	10102*
	5/16 .187 Barrel	10102E
	3/8	10103*
	1/2	10104*



16-14

	4	10084BZ
	6	10086BZ*
	6 .187 Barrel	10086 EBZ
	6 Slim	10085BZ
	8	10090BZ*
	8 Slim	10098BZ
	8 Slim .187 Barrel	10098EBZ
	10	10100BZ*
	10 .187 Barrel	10100EBZ
	1/4	10101BZ*
	1/4 Slim	10114BZ*
	1/4 Slim .187 Barrel	10114EBZ
	5/16	10102BZ*
	5/16 .187 Barrel	10102EBZ
	3/8	10103BZ*
	1/2	10104BZ*



12-10

	6	10210*
	6 Slim	10215
	8	10220*
	8 Slim	10225
	10	10230*
	1/4	10240*
	1/4 Slim	10245*
	5/16	10250*
	3/8	10260*
	1/2	10233*
	1/2 Wide	10235



12-10

	6	10210BZ*
	6 Slim	10215BZ
	8	10220BZ*
	8 Slim	10225BZ
	10	10230BZ*
	1/4	10240BZ*
	1/4 Slim	10245BZ*
	5/16	10250BZ*
	3/8	10260BZ*
	1/2	10233BZ*



NEW

Long Neck Bare Brazed

22-18	8	10030LBZ
	10	10040LBZ

16-14	8	10090LBZ
	10	10100LBZ

12-10	10	10230LBZ
-------	----	----------



8

	8	10608*
	10 Slim	10609*
	10	10610*
	1/4	10611*
	5/16	10612*
	3/8	10613*
	1/2	10614*



6

	10	10615*
	10 Slim	10615E*
	1/4	10616*
	1/4 Slim	10616E*
	5/16	10617*
	3/8	10618*
	1/2	10619*



Bare Brazed Seam

24-20	4	12404
	6	12406
	8	12408
	10	12410



4

	10 Slim	10898
	1/4	10620*
	1/4 Slim	10899
	5/16	10621*
	3/8	10622*
	1/2	10623*



2

	1/4	10628
	5/16	10629
	3/8	10630
	1/2	10631



Ring Tongues

Ring Tongue

* UL & CSA Listed Part

Vinyl Insulated

Wire Size Stud Size Part Number

24-20
4 22404
6 22406
8 22408
10 22410



22-18
4 50014
6 50020*
6 .187 Barrel 50020E
6 Slim 50021
6 Slim .187 Barrel 50021E
8 50030*
8 Slim 50038
8 Slim .187 Barrel 50038E
10 50040*
10 .187 Barrel 50040E
1/4 50041*
1/4 Slim 50044*
1/4 Slim .187 Barrel 50044E
5/16 50042*
5/16 .187 Barrel 50042E
3/8 50043*



16-14
4 50084
6 Slim 50085
6 50086*
6 .187 Barrel 50086E
8 50090*
8 Slim 50098
8 Slim .187 Barrel 50098E
10 50100*
10 .187 Barrel 50100E
1/4 50101*
1/4 Slim 50114*
1/4 Slim .187 Barrel 50114E
5/16 50102*
5/16 .187 Barrel 50102E
3/8 50103*
1/2 50104*



12-10
6 50210*
6 Slim 50215
8 50220*
8 Slim 50225
10 50230*
1/4 50240*
1/4 Slim 50245*
5/16 50250*
3/8 50260*
1/2 50233*
1/2 Wide 50235



8
8 50608
10 Slim 50609N
10 50610
1/4 50611
5/16 50612
3/8 50613
1/2 50614



6
10 50615
10 Slim 50615E
1/4 50616
1/4 Slim 50616E
5/16 50617
3/8 50618
1/2 50619



Nylon Insulated

Wire Size Stud Size Part Number

22-18
4 50014N
6 50020N*
6 .187 Barrel 50020EN
6 Slim 50021N
6 Slim .187 Barrel 50021EN
8 50030N*
8 Slim 50038N
8 Slim .187 Barrel 50038EN
10 50040N*
10 .187 Barrel 50040EN
1/4 50041N*
1/4 Slim 50044N*
1/4 Slim .187 Barrel 50044EN
5/16 50042N*
5/16 .187 Barrel 50042EN
3/8 50043N*



16-14
4 50084N
6 Slim 50085N
6 50086N*
6 .187 Barrel 50086EN
8 50090N*
8 Slim 50098N
8 Slim .187 Barrel 50098EN
10 50100N*
10 .187 Barrel 50100EN
1/4 50101N*
1/4 Slim 50114N*
1/4 Slim .187 Barrel 50114EN
5/16 50102N*
5/16 .187 Barrel 50102EN
3/8 50103N*
1/2 50104N



12-10
6 50210N*
6 Slim 50215N
8 50220N*
8 Slim 50225N
10 50230N*
1/4 50240N*
1/4 Slim 50245N*
5/16 50250N*
3/8 50260N*
1/2 50233N*



8
8 50608N
10 Slim 50609N
10 50610N
1/4 50611N
5/16 50612N
3/8 50613N
1/2 50614N



6
10 50615N
10 Slim 50615EN
1/4 50616N
1/4 Slim 50616EN
5/16 50617N
3/8 50618N
1/2 50619N



4
10 Slim 50898N
1/4 50620N
1/4 Slim 50899N
5/16 50621N
3/8 50622N
1/2 50623N

NEW

NEW

2
1/4 50628N
5/16 50629N
3/8 50630N
1/2 50631N



MORE SIZES ADDED

Ring Tongues

Ring Tongue

3-Pc Nylon w/ Sleeve

Wire Size	Stud Size	Part Number
24-20	4	32404
	6	32406
	8	32408
	10	32410



22-18	4	30014
	6	30020
	6 Slim	30021
	8	30030
	8 Slim	30038
	10	30040
	1/4	30041
	1/4 Slim	30044
	5/16	30042
	3/8	30043



16-14	4	30084
	6	30086
	6 Slim	30085
	8	30090
	8 Slim	30098
	10	30100
	1/4	30101
	1/4 Slim	30114
	5/16	30102
	3/8	30103
1/2	30104	



12-10	6	30210
	6 Slim	30215
	8	30220
	8 Slim	30225
	10	30230
	1/4	30240
	1/4 Slim	30245
	5/16	30250
3/8	30260	
1/2	30233	



Heat Shrink

Wire Size	Stud Size	Part Number
22-18	4	40014
	6	40020
	6 Slim	40021
	8	40030
	8 Long Neck	40030L
	8 Slim	40038
	10	40040
	10 Long Neck	40040L
	1/4	40041
	1/4 Slim	40044
5/16	40042	
3/8	40043	



16-14	4	40084
	6	40086
	6 Slim	40085
	8	40090
	8 Long Neck	40090L
	8 Slim	40098
	10	40100
	10 Long Neck	40100L
	1/4	40101
	1/4 Slim	40114
5/16	40102	
3/8	40103	
1/2	40104	



12-10	6	40210
	6 Slim	40215
	8	40220
	8 Slim	40225
	10	40230
	10 Long Neck	40230L
	1/4	40240
	1/4 Slim	40245
	5/16	40250
	3/8	40260
1/2	40233	



8	8	40608
	10 Slim	40609
	10	40610
	1/4	40611
	5/16	40612
	3/8	40613
	1/2	40614



New Long Necks!

Stud Size Guide

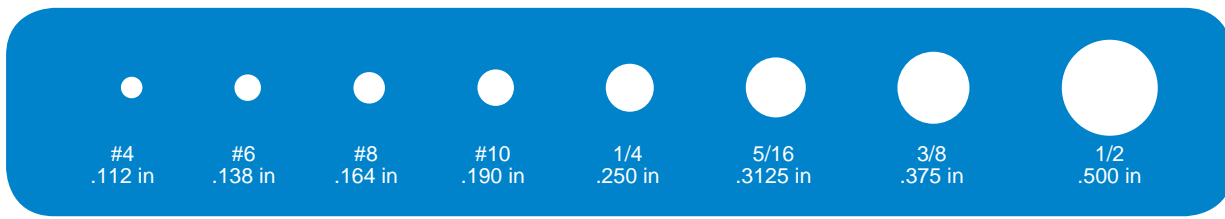

Ring Tongues

Bare Butted Seam

Wire Size	Stud Size	Part Number
-----------	-----------	-------------

22-18	6-8-10	10040M*
-------	--------	---------

16-14	6-8-10	10100M*
-------	--------	---------

12-10	6-8-10	10230M*
-------	--------	---------



Nylon Insulated

Wire Size	Stud Size	Part Number
-----------	-----------	-------------

22-18	6-8-10	50040MN*
-------	--------	----------

16-14	6-8-10	50100MN*
-------	--------	----------

12-10	6-8-10	50230MN*
-------	--------	----------



Bare Brazed Seam

22-18	6-8-10	10040MBZ*
-------	--------	-----------

16-14	6-8-10	10100MBZ*
-------	--------	-----------

12-10	6-8-10	10230MBZ*
-------	--------	-----------



3-Pc Nylon w/ Sleeve

22-18	6-8-10	30040M
-------	--------	--------

16-14	6-8-10	30100M
-------	--------	--------

12-10	6-8-10	30230M
-------	--------	--------



Vinyl Insulated

22-18	6-8-10	50040M*
-------	--------	---------

16-14	6-8-10	50100M*
-------	--------	---------

12-10	6-8-10	50230M*
-------	--------	---------



Heat Shrink

22-18	6-8-10	40040M
-------	--------	--------

16-14	6-8-10	40100M
-------	--------	--------

12-10	6-8-10	40230M
-------	--------	--------



Star Rings

Blades can pierce surfaces to ensure a good connection



Vinyl Insulated

Wire Size	Stud Size	Part Number
-----------	-----------	-------------

22-18	6 8	50301 50302
-------	--------	----------------

16-14	8 10	50305 50306
-------	---------	----------------



Bare Butted Seam

Wire Size	Stud Size	Part Number
22-18	4	10054
	6	10050*
	6 Short	10055
	8	10060*
	10	10070*
	1/4	10075



16-14	6	10140*
	8	10150*
	10	10160*
	1/4	10165*



12-10	6	10270*
	8	10280*
	10	10290*
	1/4	10234*



Bare Brazed Seam

24-20	4	12414
	6	12416
	8	12418
	10	12420



22-18	4	10054BZ
	6	10050BZ*
	6 Short	10055BZ
	8	10060BZ*
	10	10070BZ*
	1/4	10075BZ



16-14	6	10140BZ*
	8	10150BZ*
	10	10160BZ*
	1/4	10165BZ*



12-10	6	10270BZ*
	8	10280BZ*
	10	10290BZ*
	1/4	10234BZ*



8	10	10607
---	----	-------



6	1/4	10726
---	-----	-------



Vinyl Insulated

24-20	4	22414
	6	22416
	8	22418
	10	22420



22-18	4	50054
	6	50050*
	6 Short	50055
	8	50060*
	10	50070*
	1/4	50075



16-14	6	50140*
	8	50150*
	10	50160*
	1/4	50165*



12-10	6	50270*
	8	50280*
	10	50290*
	1/4	50234*



8	10	50607
---	----	-------



Nylon Insulated

22-18	4	50054N
	6	50050N*
	6 Short	50055N
	8	50060N*
	10	50070N*
	1/4	50075N



16-14	6	50140N*
	8	50150N*
	10	50160N*
	1/4	50165N*



12-10	6	50270N*
	8	50280N*
	10	50290N*
	1/4	50234N*



8	10	50607N
---	----	--------



6	1/4	20726N
---	-----	--------



Spades

Spades

3-Pc Nylon w/ Sleeve

Wire Size	Stud Size	Part Number
24-20	4	32414
	6	32416
	8	32418
	10	32420
22-18	4	30054
	6	30050
	6 Short	30055
	8	30060
	10	30070
	1/4	30075
16-14	6	30140
	8	30150
	10	30160
	1/4	30165
12-10	6	30270
	8	30280
	10	30290
	1/4	30234



Heat Shrink

Wire Size	Stud Size	Part Number
22-18	4	40054
	6	40050
	6 Short	40055
	8	40060
	10	40070
	1/4	40075
16-14	6	40140
	8	40150
	10	40160
	1/4	40165
12-10	6	40270
	8	40280
	10	40290
	1/4	40234



Flanged Spades

Bare Butted Seam

22-18	6	10053
	8	10063
	10	10073
16-14	6	10143
	8	10153
	10	10163
12-10	6	10273
	8	10283
	10	10293



Nylon Insulated

22-18	6	50053N
	8	50063N
	10	50073N
16-14	6	50143N
	8	50153N
	10	50163N
12-10	6	50273N
	8	50283N
	10	50293N

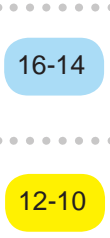

3 Piece Nylon

22-18	6	30053
	8	30063
	10	30073
16-14	6	30143
	8	30153
	10	30163
12-10	6	30273
	8	30283
	10	30293



Vinyl Insulated

22-18	6	50053
	8	50063
	10	50073
16-14	6	50143
	8	50153
	10	50163
12-10	6	50273
	8	50283
	10	50293



The parts beginning in "2" are Extruded Vinyl. The parts beginning in "5" are Injection Molded with funnel entry.

Flanged Spades are NOT brazed seam.

Heat Shrink

22-18	6	40053
	8	40063
	10	40073
16-14	6	40143
	8	40153
	10	40163
12-10	6	40273
	8	40283
	10	40293



Bare Butted Seam

Wire Size	Stud Size	Part Number
22-18	6	10052*
	6 Wide	10056
	8	10062*
	8 Slim	10068
	10	10072*



16-14	4	10144
	6	10142*
	6 Wide	10146
	8	10152*
	8 Slim	10158
	10	10162*



12-10	6	10272*
	8	10282*
	10	10292*



Bare Brazed Seam

22-18	6	10052BZ*
	6 Wide	10056BZ
	8	10062BZ*
	8 Slim	10068BZ
	10	10072BZ*



16-14	4	10144BZ
	6	10142BZ*
	6 Wide	10146BZ
	8	10152BZ*
	8 Slim	10158BZ
	10	10162BZ*



12-10	6	10272BZ*
	8	10282BZ*
	10	10292BZ*



Vinyl Insulated

22-18	6	50052*
	6 Wide	50056
	8	50062*
	8 Slim	50068
	10	50072*



16-14	4	50144
	6	50142*
	6 Wide	50146
	8	50152*
	8 Slim	50158
	10	50162*



12-10	6	50272*
	8	50282*
	10	50292*



Nylon Insulated

22-18	6	50052N*
	6 Wide	50056N
	8	50062N*
	8 Slim	50068N
	10	50072N*



16-14	4	50144N
	6	50142N*
	6 Wide	50146N
	8	50152N*
	8 Slim	50158N
	10	50162N*



12-10	6	50272N*
	8	50282N*
	10	50292N*



3-Pc Nylon w/ Sleeve

22-18	6	30052
	6 Wide	30056
	8	30062
	8 Slim	30068
	10	30072



16-14	4	30144
	6	30142
	6 Wide	30146
	8	30152
	8 Slim	30158
	10	30162



12-10	6	30272
	8	30282
	10	30292



Heat Shrink

22-18	6	40052
	6 Wide	40056
	8	40062
	8 Slim	40068
	10	40072



16-14	4	40144
	6	40142
	6 Wide	40146
	8	40152
	8 Slim	40158
	10	40162



12-10	6	40272
	8	40282
	10	40292



Bare Butted Seam

Wire Size	Stud Size	Part Number
22-18	6	10051*
	8	10061*
	10	10071*
.....		
16-14	6	10141*
	8	10151*
	10	10161*
.....		
12-10	6	10271*
	8	10281*
	10	10291*
	1/4	10241*

Nylon Insulated

Wire Size	Stud Size	Part Number
22-18	6	50051N*
	8	50061N*
	10	50071N*
.....		
16-14	6	50141N*
	8	50151N*
	10	50161N*
.....		
12-10	6	50271N*
	8	50281N*
	10	50291N*
	1/4	50241N*

Bare Brazed Seam

Wire Size	Stud Size	Part Number
22-18	6	10051BZ*
	8	10061BZ*
	10	10071BZ*
.....		
16-14	6	10141BZ*
	8	10151BZ*
	10	10161BZ*
.....		
12-10	6	10271BZ*
	8	10281BZ*
	10	10291BZ*
	1/4	10241BZ*

3-Pc Nylon w/ Sleeve

Wire Size	Stud Size	Part Number
22-18	6	30051
	8	30061
	10	30071
.....		
16-14	6	30141
	8	30151
	10	30161
.....		
12-10	6	30271
	8	30281
	10	30291
	1/4	30241

Vinyl Insulated

Wire Size	Stud Size	Part Number
22-18	6	50051*
	8	50061*
	10	50071*
.....		
16-14	6	50141*
	8	50151*
	10	50161*
.....		
12-10	6	50271*
	8	50281*
	10	50291*
	1/4	50241*

Heat Shrink

Wire Size	Stud Size	Part Number
22-18	6	40051
	8	40061
	10	40071
.....		
16-14	6	40141
	8	40151
	10	40161
.....		
12-10	6	40271
	8	40281
	10	40291
	1/4	40241

Bare Butted Seam

Wire Size	Stud Size	Part Number
22-18	6	10067
	8	10077
	10	10087



16-14	6	10105*
	8	10110*
	10	10120*



12-10	6	10128
	8	10129
	10	10130*



Bare Brazed Seam

22-18	6	10067BZ
	8	10077BZ
	10	10087BZ



16-14	6	10105BZ*
	8	10110BZ*
	10	10120BZ*



12-10	10	10130BZ*
-------	----	----------



Vinyl Insulated

22-18	6	50067
	8	50077
	10	50087



16-14	6	50105*
	8	50110*
	10	50120*



12-10	6	50128
	8	50129
	10	50130*



Nylon Insulated

Wire Size	Stud Size	Part Number
22-18	6	50067N
	8	50077N
	10	50087N



16-14	6	50105N*
	8	50110N*
	10	50120N*



12-10	6	50128N
	8	50129N
	10	50130N*



3-Pc Nylon w/ Sleeve

22-18	6	30067
	8	30077
	10	30087



16-14	6	30105
	8	30110
	10	30120



12-10	6	30128
	8	30129
	10	30130



Heat Shrink

22-18	6	40067
	8	40077
	10	40087



16-14	6	40105
	8	40110
	10	40120



12-10	6	40128
	8	40129
	10	40130



Nylon Insulated Brazed Barrel

NEW SERIES OF TERMINALS

The brazed seam will not separate under pressure of operating stress.

A funnel entry nylon insulator allows easy insertion.

Rings

Wire Size	Stud Size	Part Number
22-18	6	50020BZN
	8	50030BZN
	10	50040BZN
	6-8-10	50040MBZN
	1/4	50041BZN
	5/16	50042BZN
3/8	50043BZN	



16-14	6	50086BZN
	8	50090BZN
	10	50100BZN
	6-8-10	50100MBZN
	1/4	50101BZN
	5/16	50102BZN
3/8	50103BZN	



12-10	6	50210BZN
	8	50220BZN
	10	50230BZN
	6-8-10	50230MBZN
	1/4	50240BZN
	5/16	50250BZN
3/8	50260BZN	
1/2	50233BZN	



Multi Stud Ring

22-18	6-8-10	50040MBZN
-------	--------	-----------

16-14	6-8-10	50100MBZN
-------	--------	-----------

12-10	6-8-10	50230MBZN
-------	--------	-----------



Male Quick Disconnects

22-18	.250 x .032	50177BZN
-------	-------------	----------

16-14	.250 x .032	50181BZN
-------	-------------	----------

12-10	.250 x .032	50186BZN
-------	-------------	----------



Spades

Wire Size	Stud Size	Part Number
22-18	6	50050BZN
	8	50060BZN
	10	50070BZN



16-14	6	50140BZN
	8	50150BZN
	10	50160BZN



12-10	6	50270BZN
	8	50280BZN
	10	50290BZN



Snap Spades

22-18	6	50051BZN
	8	50061BZN
	10	50071BZN



16-14	6	50141BZN
	8	50151BZN
	10	50161BZN



12-10	6	50271BZN
	8	50281BZN
	10	50291BZN
	1/4	50241BZN



Block Spades

22-18	6	50052BZN
	8	50062BZN
	10	50072BZN



16-14	6	50142BZN
	8	50152BZN
	10	50162BZN



12-10	6	50272BZN
	8	50282BZN
	10	50292BZN



High Temperature Terminals

Non-Insulated Butted Seam Terminals are made of steel. They are nickel plated for temperatures up to 900° F (482° C)

Rings

Wire Size	Tab Width	Steel Nickel Plated
-----------	-----------	---------------------

22-18	6	10020HT
	8	10030HT
	8	10038HT
	10	10040HT
	1/4	10041HT
	5/16	10042HT
3/8	10043HT	



16-14	6	10086HT
	8	10090HT
	10	10100HT
	1/4 Slim	10114HT
	1/4	10101HT
	5/16	10102HT
3/8	10103HT	



12-10	6	10210HT
	8	10220HT
	10	10230HT
	1/4 Slim	10245HT
	1/4	10240HT
	5/16	10250HT
3/8	10260HT	



8	10	10610HT
	1/4	10611HT
	5/16	10612HT
	3/8	10613HT



6	10	10615HT
	1/4	10616HT
	5/16	10617HT
	3/8	10618HT



4	5/16	10621HT
	3/8	10622HT



2	3/8	10630HT
---	-----	---------



Butt Connectors

22-18	10080HT
-------	---------



16-14	10170HT
-------	---------



12-10	10310HT
-------	---------



Quick Connects

Wire Size	Tab Width	Steel Nickel Plated
-----------	-----------	---------------------

22-18	.250 x .032 Fem.	10176HT
	.250 x .032 Male	10177HT
	.187 x .020 Fem.	10192HT

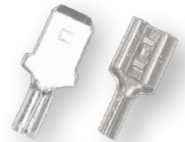

16-14	.187 x .020 Fem.	10195HT
	.250 x .032 Fem.	10180HT
	.250 x .032 Male	10181HT

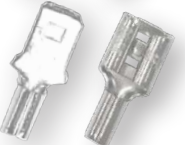

12-10	.250 x .032 Fem.	10187HT
	.250 x .032 Male	10186HT

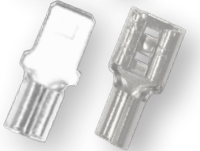

Spades

22-18	6	10050HT
	8	10060HT
	10	10070HT



16-14	6	10140HT
	8	10150HT
	10	10160HT



12-10	6	10270HT
	8	10280HT
	10	10290HT
	1/4	10234HT



Block Spade

16-14	8	10152HT
-------	---	---------



12-10	10	10292HT
-------	----	---------

Flags

16-14	.250 Fem.	10189HT
-------	-----------	---------



Piggyback Connectors

Bare Butted Seam

Wire Size	Tab Width	Part Number
-----------	-----------	-------------

22-18	.250 x .032	10662
-------	-------------	-------

16-14	.250 x .032	10663
-------	-------------	-------

12-10	.250 x .032	10666
-------	-------------	-------



3-Pc Nylon w/ Sleeve

Wire Size	Tab Width	Part Number
-----------	-----------	-------------

22-18	.250 x .032	30662
-------	-------------	-------

16-14	.250 x .032	30663
-------	-------------	-------



Vinyl Insulated

22-18	.250 x .032	20662
-------	-------------	-------

16-14	.250 x .032	20663
-------	-------------	-------

12-10	.250 x .032	20664
-------	-------------	-------



NEW

3-Pc Nylon Fully Insulated

22-18	.250 x .032	32662
-------	-------------	-------

16-14	.250 x .032	32663
-------	-------------	-------



NEW

Nylon Insulated

22-18	.250 x .032	20662N
-------	-------------	--------

16-14	.250 x .032	20663N
-------	-------------	--------

12-10	.250 x .032	20664N
-------	-------------	--------



Heat Shrink

22-18	.250 x .032	40662
-------	-------------	-------

16-14	.250 x .032	40663
-------	-------------	-------

12-10	.250 x .032	40664
-------	-------------	-------



Closed End Connectors

Copper Insert

Wire Size	Part Number
-----------	-------------

22-18	20569
-------	-------

16-14	20570
-------	-------

12-10	20571
-------	-------

8	20572
---	-------



Aluminum Insert

Wire Size	Part Number
-----------	-------------

22-18	20569A
-------	--------

16-14	20570A
-------	--------

12-10	20571A
-------	--------

8	20572A
---	--------



See Page 37 for corresponding [Tool \(20709\)](#)

Female Quick Disconnects

Bare Butted Seam

Wire Size	Tab Width	Part Number
22-18	.110 x .020	10191
	.187 x .020	10192
	.205 x .020	10193
	.250 x .032	10176
.....		
16-14	.110 x .020	10194
	.187 x .020	10195
	.205 x .020	10196
	.250 x .032	10180
.....		
12-10	.250 x .032	10187
	.375 x .032	10166



3-Pc Nylon w/ Sleeve

Wire Size	Tab Width	Part Number
22-18	.110 x .020	30191
	.187 x .020	30192
	.205 x .020	30193
	.250 x .032	30176
.....		
16-14	.110 x .020	30194
	.187 x .020	30195
	.205 x .020	30180
	.375 x .032	30375
.....		
12-10	.187 x .032	30167
	.250 x .032	30187
	.375 x .032	30166
	Larger Barrel .250 X .032	30187B



Vinyl Insulated

22-18	.110 x .020	20191
	.187 x .020	20192
	.187 x .020	50192
	.205 x .020	20193
	.205 x .020	50193
16-14	.250 x .032	50176
	.110 x .020	20194
	.187 x .020	20195
	.187 x .020	50195
	.205 x .020	20196
12-10	.205 x .020	50196
	.250 x .032	50180
	.375 x .032	20375
	.187 x .032	20167
	.250 x .032	50187
Larger Barrel	.375 x .032	20166
	.250 X .032	50187B



Heat Shrink

22-18	.110 x .020	40191
	.187 x .020	40192
	.250 x .032	40176
.....		
16-14	.110 x .020	40194
	.187 x .020	40195
	.250 x .032	40180
.....		
12-10	.250 x .032	40187
	.375 X .032	40166



Nylon Insulated

22-18	.187 x .020	50192N
	.205 x .020	50193N
	.250 x .032	50176N
.....		
16-14	.187 x .020	20195N
	.187 x .020	50195N
	.205 x .020	50196N
	.250 x .032	50180N
	.375 x .032	20375N
.....		
12-10	.187 x .032	20167N
	.250 x .032	50187N
	.375 x .032	20166N



The parts beginning in "2" are Extruded Vinyl.
The parts beginning in "5" are Injection Molded with funnel entry.

Female Quick Disconnects

Bare Butted Seam

Wire Size	Tab Width	Part Number
22-18	.110 x .020	10088
	.187 x .020	10197
	.250 x .032	10177*



16-14	.110 x .020	10089
	.187 x .020	10198
	.250 x .032	10181



12-10	.250 x .032	10186*
-------	-------------	--------



Bare Brazed Seam

22-18	.250 x .032	10177BZ
	.187 x .020	10197BZ



16-14	.250 x .032	10181BZ
	.187 x .020	10198BZ



12-10	.250 x .032	10186BZ
-------	-------------	---------



Vinyl Insulated

22-18	.110 x .020	20088
	.187 x .020	50197
	.250 x .032	50177*



16-14	.110 x .020	20089
	.187 x .020	50198
	.250 x .032	50181



12-10	.250 x .032	50186*
-------	-------------	--------



Nylon Insulated

22-18	.250 x .032	50177N*
	.187 x .020	50197N



16-14	.187 x .020	20198N
	.250 x .032	50181N*



12-10	.250 x .032	50186N*
-------	-------------	---------



3-Pc Nylon w/ Sleeve

22-18	.187 x .020	30197
	.250 x .032	30177



16-14	.187 x .020	30198
	.250 x .032	30181



12-10	.250 x .032	30186
-------	-------------	-------



Heat Shrink

22-18	.187 x .020	40197
	.250 x .032	40177



16-14	.187 x .020	40198
	.250 x .032	40181



12-10	.250 x .032	40186
-------	-------------	-------



Quick Disconnects - Fully Insulated

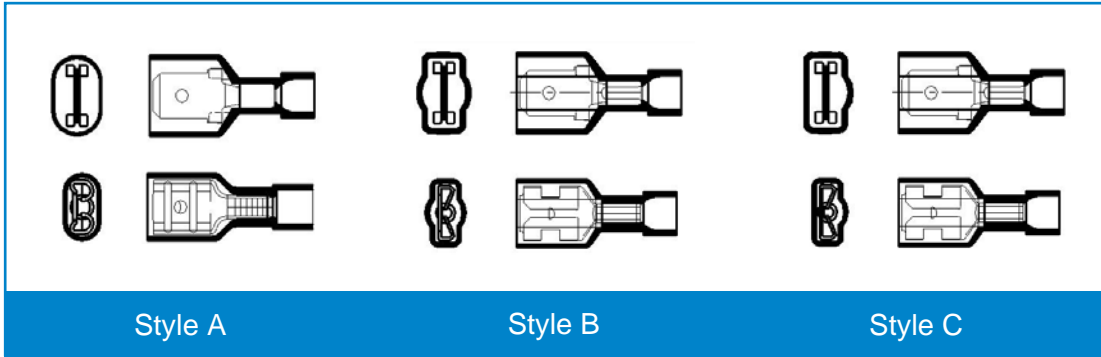

Nylon

Wire Size	Style	Tab Width	Part Number
22-18	A	.250 x .032 MALE	20178
	A	.250 x .032 FEM.	20179
	B	.250 x .032 MALE	50206
	B	.250 x .032 FEM.	50207
	C	.250 x .032 MALE	50206-1Hump
	C	.250 x .032 FEM.	50207-1Hump
16-14	A	.250 x .032 MALE	20182
	A	.250 x .032 FEM.	20183
	B	.250 x .032 MALE	50208
	B	.250 x .032 FEM.	50209
	C	.250 x .032 MALE	50208-1Hump
	C	.250 x .032 FEM.	50209-1Hump
12-10	C	.250 x .032 FEM.	50213-1Hump
	B	.250 x .032 MALE	50212
	B	.250 x .032 FEM.	50213

3-Pc Fully Nylon w/Sleeve

22-18	A	.110 x .020 FEM.	32191	NEW
	C	.187 x .020 MALE	32197	
	C	.187 x .020 FEM.	32192	
	A	.250 x .032 MALE	30178	
	A	.250 x .032 FEM.	30179	
16-14	C	.187 x .020 MALE	32198	NEW
	C	.187 x .020 FEM.	32195	
	A	.250 x .032 MALE	30182	
	A	.250 x .032 FEM.	30183	
12-10	C	.250 x .032 FEM.	30199	

Fully Insulated Vinyl **NEW**

16-14	A	.187 x .020 FEM.	52195
-------	---	------------------	-------

Heat Shrink

Wire Size	Style	Tab Width	Part Number
22-18	A	.250 x .032 MALE	44178
	A	.250 x .032 FEM.	44179
	B	.250 x .032 MALE	40206
	B	.250 x .032 FEM.	40207
16-14	A	.250 x .032 MALE	44182
	A	.250 x .032 FEM.	44183
	B	.250 x .032 MALE	40208
	B	.250 x .032 FEM.	40209
12-10	B	.250 x .032 MALE	40212
	B	.250 x .032 FEM.	40213

NEW Style: Tubing has been shortened to expose the improved crimping area.



Heat Shrink (NEW STYLE)

22-18	B	.250 x .032 MALE	90206
	B	.250 x .032 FEM.	90207
16-14	B	.250 x .032 MALE	90208
	B	.250 x .032 FEM.	90209

Q.D. - Fully Insulated

Bullet Connectors

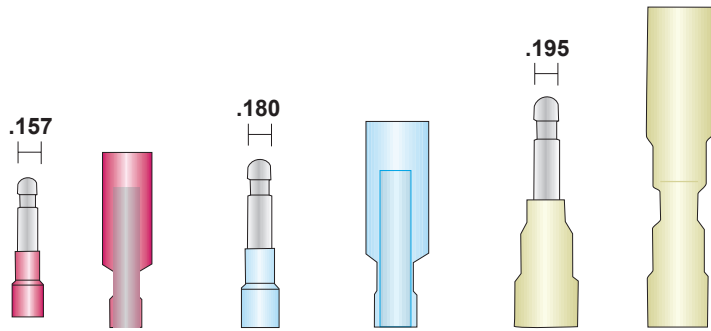

Bare Butted Seam

Wire Size	Tab Width	Part Number
22-18	.157 Male	10284
	.157 Fem.	10285
16-14	.157 Male	10184
	.157 Fem.	10185
	.195 Male	10484
12-10	.195 Male	10384

Vinyl Insulated

22-18	.157 Male	20284V
	.157 Fem.	20285V
	.180 Male	20784V
	.180 Female	20785V
16-14	.157 Male	20184V
	.157 Fem.	20185V
	.180 Male	20684V
	.180 Fem.	20685V
	.195 Male	20484V
	.195 Fem.	20485V
12-10	.195 Male	20384V
	.195 Fem.	20385V

Nylon Insulated

22-18	.157 Male	20884 Fully	NEW
	.157 Fem.	20284	
	.157 Fem.	20285	
	.180 Male	20784	
	.180 Fem.	20785	
16-14	.157 Male	20984 Fully	NEW
	.157 Male	20184	
	.157 Fem.	20185	
	.180 Fem.	20685	

3-Pc Nylon w/ Sleeve

Wire Size	Tab Width	Part Number	
22-18	.157 Male	30884 Fully	NEW
	.157 Male	30284	
	.157 Fem.	30285	
16-14	.157 Male	30984 Fully	NEW
	.157 Male	30184	
	.157 Fem.	30185	

Heat Shrink

22-18	.157 Male	40284
	.157 Fem.	40285
	.180 Male	40784
	.180 Fem.	40785
16-14	.157 Male	40184
	.157 Fem.	40185
	.180 Male	40684
	.180 Fem.	40685
	.195 Male	40484
	.195 Fem.	40485
12-10	.195 Male	40384
	.195 Fem.	40385



Heat Shrink (NEW STYLE)

22-18	.157 Fem.	90285
16-14	.157 Male	90185

3 Way Connectors

Bare Butted Seam

Wire Size	Part Number
-----------	-------------

22-18	10400
-------	-------

16-14	10410
-------	-------

12-10	10420
-------	-------

Brazed Seam

22-18	10400BZ
-------	---------

16-14	10410BZ
-------	---------

12-10	10420BZ
-------	---------

Vinyl

22-18	50400
-------	-------

16-14	50410
-------	-------

12-10	50420
-------	-------

Nylon

Wire Size	Part Number
-----------	-------------

22-18	50400N
-------	--------

16-14	50410N
-------	--------

12-10	50420N
-------	--------

3-Pc Nylon w/ Sleeve

22-18	30400
-------	-------

16-14	30410
-------	-------

12-10	30420
-------	-------

Heat Shrink

22-18	40400
-------	-------

16-14	40410
-------	-------

12-10	40420
-------	-------



4 Way Connectors

Bare Butted Seam

22-18	10430
-------	-------

16-14	10440
-------	-------

12-10	10450
-------	-------

Brazed Seam

22-18	10430BZ
-------	---------

16-14	10440BZ
-------	---------

12-10	10450BZ
-------	---------

Vinyl

22-18	50430
-------	-------

16-14	50440
-------	-------

12-10	50450
-------	-------

Nylon

22-18	50430N
-------	--------

16-14	50440N
-------	--------

12-10	50450N
-------	--------

3-Pc Nylon w/ Sleeve

22-18	30430
-------	-------

16-14	30440
-------	-------

12-10	30450
-------	-------

Heat Shrink

22-18	40430
-------	-------

16-14	40440
-------	-------

12-10	40450
-------	-------



Pin Terminals

Uninsulated Butted Seam

Wire Size Part Number

22-18 UPT1



16-14 UPT2



12-10 UPT5



Vinyl Insulated

Wire Size Part Number

22-18 PTV1



16-14 PTV2



12-10 PTV5
PTV5UL



2-Pc Nylon

Wire Size Part Number

22-18 PTN1 **NEW**



16-14 PTN2 **NEW**



12-10 PTN5 **NEW**



3-Pc Nylon w/ Sleeve

Wire Size Part Number

22-18 PT3N1



16-14 PT3N2



12-10 PT3N5



Flags

Non Insulated

Wire Size Part Number Tab Width

22-18 12188
10188 .187 **NEW**



16-14 12189
10189
10669 (male) .187 **NEW**



12-10 10190 .250



Heat Shrink

Wire Size Part Number Tab Width

22-18 42188
40188 .187 **NEW**



16-14 42189
40189 .187 **NEW**



12-10 40190 .250



Nylon Insulated

22-18 22188
20188 .187 **NEW**



16-14 22189
20189 .187 **NEW**



12-10 20190 .250



See Page 37 [Tool \(20594\)](#) for 22-18 and 16-14
and [Tool \(20704\)](#) for 16-14 and 12-10.

VOLTAGE RATINGS

Insulated Copper Terminals
Insulated Brass Disconnects
Tap Splices (16-10AWG)
Tap Splices (18AWG)

600 volts MAX
300 volts MAX
32 volts MAX
18 volts MAX

Heat Shrink Terminals

Crimp & Seal (A)



Solder & Seal (B)



Crimp, Solder & Seal (C)



Crimp & Seal (A)

Solder & Seal (B)

Crimp, Solder & Seal (C)

The terminals are copper (.110 alloy). The tubing is a high quality polyolefin. Seamless connectors used on butts. Multiple wall heat shrinkable tubing, clearly marked. Rings and spades are brazed seam. Color coded with wire size.

Description	Wire Size	Stud/Tab Width	Crimp & Seal (A)	Solder & Seal (B)	Crimp, Solder & Seal (C)	NYAX Crimp & Seal (A)
Butts	24-20		40024	60024	80024	
	22-18		20082	60082	80082	40082
	16-14		20172	60172	80172	40172
	12-10		20312	60312	80312	40312
Rings	22-18	6	40020	60020	80020	70020
		8	40030	60030	80030	70030
		10	40040	60040	80040	70040
		1/4	40041	60041	80041	70041
		5/16	40042	60042	80042	70042
		3/8	40043	60043	80043	70043
	16-14	8	40090	60090	80090	70090
		10	40100	60100	80100	70100
		1/4	40101	60101	80101	70101
		5/16	40102	60102	80102	70102
		3/8	40103	60103	80103	70103
	12-10	10	40230	60230	80230	70230
		1/4	40240	60240	80240	70240
		5/16	40250	60250	80250	70250
3/8		40260	60260	80260	70260	
1/2		40233	60233	80233	70233	
Spade	22-18	10	40070	60070	80070	70070
	16-14	10	40160	60160	80160	70160
	12-10	10	40290	60290	80290	70290
Quick Disconnects	22-18	.250 Fem.	40176	60176	80176	70176
		.250 Male	40177	60177	80177	70177
	16-14	.250 Fem.	40180	60180	80180	70180
		.250 Male	40181	60181	80181	70181
	12-10	.250 Fem.	40187	60187	80187	70187
		.250 Male	40186	60186	80186	70186
Fully Insulated QDC	22-18	.250 Fem.	40207	60179	80179	70207
	16-14	.250 Fem.	40209	60183	80183	70209
	12-10	.250 Fem.	40213	60199	80199	70213
Heat Shrink Fully Insulated Female Disconnects						

Brass support sleeve for improved pull-out force resistance.



Fully Insulated QDC	16-14	.250 Fem.	40180BRS
	12-10	.250 Fem.	40187BRS



Heat Shrink Tubing

Dual Wall - Adhesive Lined

Shrink Ratio 2.5 to 1

Wire Size	Color	O.D. x Length	Part Number
22-16	Red	3/16" x 6"	23280
16-14	Blue	1/4" x 6"	23281
12-10	Yellow	5/16" x 6"	23282

Thin Wall - No Adhesive

Shrink Ratio 2 to 1

Wire Size	Color	O.D. x Length	Part Number
22-16	Black	1/4" x 3"	23123
16-14	Black	3/8" x 3"	23125
12-10	Black	1/2" x 3"	23127

Single Wall - No Adhesive

Shrink Ratio 2 to 1

Wire Size	Color	O.D. x Length	Part Number
24-20	Black	1/8" x 4'	23603
20-14	Black	3/16" x 4'	23604
14-8	Black	1/4" x 4'	23605
10-6	Black	5/16" x 4'	23606
8-4	Black	3/8" x 4'	23607
4-1	Black	1/2" x 4'	23608

Dual Wall - Adhesive Lined

Shrink Ratio 3 to 1

Wire Size	Expanded Diameter	Black	Clear	Red
24-16	1/8" x 6"	23525-06B	23525-06C	23525-06R
20-12	3/16" x 6"	23530-06B	23530-06C	23530-06R
12-8	1/4" x 6"	23535-06B	23535-06C	23535-06R
10-4	3/8" x 6"	23540-06B	23540-06C	23540-06R
8-1	1/2" x 6"	23545-06B	23545-06C	23545-06R
4-250MCM	3/4" x 6"	23550-06B	23550-06C	23550-06R
1-500MCM	1" x 6"	23555-06B	23555-06C	23555-06R
600-700 MCM	1 1/4" x 6"	23560-06B	23560-06C	23560-06R
800-1000 MCM	1 1/2" x 6"	23565-06B	23565-06C	23565-06R
1000-1250 MCM	2" x 6"	23570-06B	23570-06C	23570-06R

SHRINK TUBING CHART

Tubing O.D.	Non Insulated	Vinyl/ Nylon	Copper Lugs	Heavy Duty Lugs	Battery Terminals
3/32"	26-24				
1/8"	22-18	26-24			
3/16"	16-14	22-18			
1/4"	12-10	16-14			
3/8"	8-6	12-10	8-6	8-4	
1/2"	4-2	8-6	4-1/0	1	4
3/4"	1/0-3/0	4-1/0	2/0-4/0	1/0-3/0	1-3/0
1"		2/0-3/0	250MCM	4/0	4/0

WIRE SIZE CROSS REFERENCE

Metric mm ²	AWG
0.5	26-22
1.25	22-16
2.0	16-14
5.5	12-10
8.0	8
14.0	6
22.0	4
35.0	2
60.0	1/0
70.0	2/0
80.0	3/0
100.0	4/0

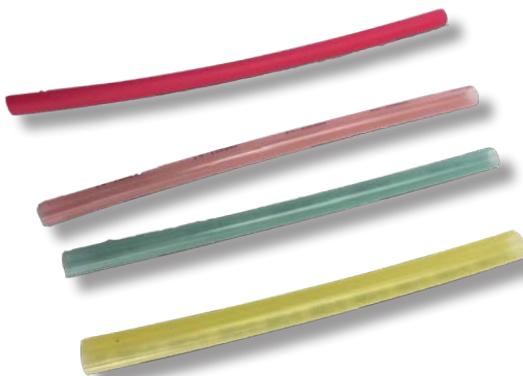

Heat Shrink Tubing on a Reel 2:1 100ft

NEW

Part Number

23610	1/8" Black 2:1 Heat Shrink 100ft Reel
23611	3/16" Black 2:1 Heat Shrink 100ft Reel
23612	1/4" Black 2:1 Heat Shrink 100ft Reel
23613	3/8" Black 2:1 Heat Shrink 100ft Reel
23614	1/2" Black 2:1 Heat Shrink 100ft Reel
23615	3/4" Black 2:1 Heat Shrink 100ft Reel
23616	1" Black 2:1 Heat Shrink 100ft Reel

Heat Shrink Tubing on a Reel 3:1

NEW

Part Number

23710	1/8" Black 3:1 Heat Shrink 660ft Reel
23711	3/16" Black 3:1 Heat Shrink 330ft Reel
23712	1/4" Black 3:1 Heat Shrink 330ft Reel
23713	3/8" Black 3:1 Heat Shrink 330ft Reel
23714	1/2" Black 3:1 Heat Shrink 100ft Reel
23715	3/4" Black 3:1 Heat Shrink 100ft Reel
23716	1" Black 3:1 Heat Shrink 100ft Reel

Heat Shrink 3:1 Black 4ft

NEW

Part Number

23525-48B	1/8" 3:1 Black 4ft cut length
23530-48B	3/16" 3:1 Black 4ft cut length
23535-48B	1/4" 3:1 Black 4ft cut length
23540-48B	3/8" 3:1 Black 4ft cut length
23545-48B	1/2" 3:1 Black 4ft cut length
23550-48B	3/4" 3:1 Black 4ft cut length
23555-48B	1" 3:1 Black 4ft cut length

Parallel Connectors

Bare Seamless

Wire Size	Part Number
22-18	10647
16-14	10648
12-10	10649
8	10650
6	10651
4	10652
2	10653



*Only one crimp needed to complete splice



2 Pc. Nylon

Wire Size	Part Number
22-18	20647N
16-14	20648N
12-10	20649N
8	20650N



Vinyl Insulated

Wire Size	Part Number
22-18	20647
16-14	20648
12-10	20649
8	20650



Heat Shrink

Wire Size	Part Number
22-18	40647
16-14	40648
12-10	40649
8	40650



Adapters

Double Male Single Female Brass

10664



3-Way Adapter Brass

10665



Chair Adapter Brass

10667



2-Way Bullet Receptacle

10668



Insulated Double Male 75°C 300 volts

10670



Insulated Triple Male 75°C 300 volts max

10671



ATO Fuse Tap Brass

10672
10672-mini



Glass Fuse Tap Brass

10673



All Adapters have .250 tabs, except the 2-Way Bullet Receptacle which has a .157 Tab

Ferrule Wire Ends

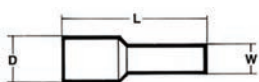

Wire Size	Color	Part Number	Dimensions
22	White	10822	.551 x .051 x .122
20	Blue	10820	.551 x .061 x .130
18	Red	10818	.551 x .061 x .138
16	Black	10816	.551 x .083 x .157
14	Gray	10814	.551 x .102 x .185
12	Orange	10812	.669 x .134 x .213
10	Green	10810	.787 x .161 x .272



* Copper Ferrule with nylon insulation



Crimps 22-10
Part # 20598
Length 9.3"

Heavy Duty Electrical Lugs

Unplated

Wire Size Stud Size Part Number

8

10
1/4
5/16
3/8
1/2
8101-00
8141-00
8562-00
8382-00
8503-00



6

10
1/4
5/16
3/8
1/2
6101-00
6141-00
6562-00
6382-00
6503-00



4

10
1/4
5/16
3/8
1/2
4101-00
4141-00
4562-00
4382-00
4503-00



2

1/4
5/16
3/8
1/2
2141-00
2561-00
2381-00
2503-00



1

1/4
5/16
3/8
1/2
1141-00
1561-00
1381-00
1503-00



1/0

1/4
5/16
3/8
1/2
10141-00
10561-00
10381-00
10501-00



2/0

1/4
5/16
3/8
1/2
20141-00
20561-00
20381-00
20501-00



3/0

3/8
1/2
5/16
30381-00
30501-00
30561-00



4/0

3/8
1/2
40381-00
40501-00



Plated

Wire Size Stud Size Part Number

8

10
1/4
5/16
3/8
1/2
8101-60
8141-60
8562-60
8382-60
8503-60



6

10
1/4
5/16
3/8
1/2
6101-60
6141-60
6562-60
6382-60
6503-60



4

10
1/4
5/16
3/8
1/2
4101-60
4141-60
4562-60
4382-60
4503-60



2

1/4
5/16
3/8
1/2
2141-60
2561-60
2381-60
2503-60



1

1/4
5/16
3/8
1/2
1141-60
1561-60
1381-60
1503-60



1/0

1/4
5/16
3/8
1/2
10141-60
10561-60
10381-60
10501-60



2/0

1/4
5/16
3/8
1/2
20141-60
20561-60
20381-60
20501-60



3/0

1/4
5/16
3/8
1/2
30141-60
30561-60
30381-60
30501-60



4/0

1/4
5/16
3/8
1/2
40141-60
40561-60
40381-60
40501-60



4 ga & 6 ga

10
1/4
5/16
3/8
4382-60-90
4141-60-90
4562-60-90
6562-60-90

Other Size Available



Metric & AWG Wire Size

mm ²	AWG
1	16
2	14
3	12
4-5	10
6-8	8
9-13	6
14-21	4
22-35	2
36-42	1
43-53	1/0
54-68	2/0
69-86	3/0
87-107	4/0

Plated

Wire Size Part Number

8	8001-25
6	6001-25
4	4001-25
2	2001-25
1	1001-25
1/0	10001-25
2/0	20001-25
3/0	30001-25
4/0	40000-25



Battery Terminals

Top Post Straights

Wire Size	Post Type	Part Number	Color Code
6 GA	Universal	C2101T	Gray
4 GA	Universal	C2102T	Gray
4 GA	Negative	C2103T	Gray
4 GA	Positive	C2104T	Gray
2 GA	Negative	C2105T	Green
2 GA	Positive	C2106T	Green
1 GA	Negative	C2107T	Pink
1 GA	Positive	C2108T	Pink
1/0	Negative	C2109T	Black
1/0	Positive	C2110T	Black
2/0	Negative	C2111T	Orange
2/0	Positive	C2112T	Orange
3/0	Negative	C2113T	Purple
3/0	Positive	C2114T	Purple
4/0	Negative	C2115T	Yellow
4/0	Positive	C2116T	Yellow



Top Post Left Elbows

Wire Size	Post Type	Part Number	Color Code
1/0	Negative	C2409T	Black
1/0	Positive	C2410T	Black
2/0	Negative	C2411T	Orange
2/0	Positive	C2412T	Orange
3/0	Negative	C2413T	Purple
3/0	Positive	C2414T	Purple
4/0	Negative	C2415T	Yellow
4/0	Positive	C2416T	Yellow



Top Post Right Angles (Flag)

Wire Size	Post Type	Part Number	Color Code
1/0	Negative	C2209T	Black
1/0	Positive	C2210T	Black
2/0	Negative	C2211T	Orange
2/0	Positive	C2212T	Orange
3/0	Negative	C2213T	Purple
3/0	Positive	C2214T	Purple
4/0	Negative	C2215T	Yellow
4/0	Positive	C2216T	Yellow



Stud - Side Mount Straights

Wire Size	Post Type	Part Number	Color Code
4 GA	Universal	C2602T	Green
1-2 GA	Universal	C2607T	Pink
1/0	Universal	C2609T	Black
2/0	Universal	C2611T	Orange
3/0	Universal	C2613T	Purple



Stud - Side Mount (Splice)

Wire Size	Post Type	Part Number	Color Code
1/0	Universal	C2709T	Black
2/0	Universal	C2711T	Orange
3/0	Universal	C2713T	Purple



Exceeds SAE conductivity standards

Top Post Right Elbows

Wire Size	Post Type	Part Number	Color Code
1/0	Negative	C2309T	Black
1/0	Positive	C2310T	Black
2/0	Negative	C2311T	Orange
2/0	Positive	C2312T	Orange
3/0	Negative	C2313T	Purple
3/0	Positive	C2314T	Purple
4/0	Negative	C2315T	Yellow
4/0	Positive	C2316T	Yellow



Extra Nuts & Bolts Available

- Made of cast copper, tin plated to resist corrosion
- Exceeds SAE conductivity standards, J163 and J1811
- Permanent indelible, readable gauge and polarity stamped on clamp
- Quick Connectors are listed by UL (UL STD. 486A), when applied with Quick Cable HexCrimp tools 4255-001, 4255-001M or 4255-001R
- Made in U.S.A.

Part Number - Nuts & Bolts



Battery Covers

Medium Duty Starter

Wire Size	Color	Part Number
8-2	Black	7001B
	Red	7001R



Alternator Caps

1-8-10	Black	7003B
	Red	7003R
6-2/0	Black	7703B
	Red	7703R



Straight Cover

8-6	Black	7006B
	Red	7006R
1/0	Black	7007B
	Red	7007R
2/0	Black	7008B
	Red	7008R



Protects live wire power connections from accidental shorts. High temperature PVC construction rated at 190° F / 90° C.

Terminal Insulator

Wire Size	Width x Height (Inches)	Part Number
18-10	.472 x .870	7009R
	.551 x .870	7010R
	.709 x .870	7011R
8-1	.472 x .870	7012R
	.551 x .870	7013R
	.630 x .870	7014R
	.709 x .870	7015R
	.787 x .940	7016R
2-2/0	.787 x .940	7017R
	.866 x 1.05	7018R
	.945 x 1.13	7019R
	1.26 x 1.16	7020R



Universal Marine Cap

This cap will swivel to accommodate the cable direction. For use with single or multiple cables up to 19mm (0.75")

7024R



Battery Cables

Battery Cable is the OEM standard. Our battery cable meets or exceeds standards established by the Society of Automotive Engineers, (SAE). Battery cable, insulated with PVC, is flame retardant & resistant to fuel, oil, acid and salt.

Gauge	Color Coded Stripe	Battery Cable with PVC insulation	
		Black	Red
8	Gray	58008-25B	58008-25R
6	Gray	58006-25B	58006-25R
4	Gray	58004-25B	58004-25R
2	Green	58002-25B	58002-25R
1	Pink	58001-25B	58001-25R
1/0	Black	58010-25B	58010-25R
2/0	Orange	58020-25B	58020-25R
3/0	Purple	58030-25B	58030-25R
4/0	Yellow	58040-25B	58040-25R



25ft
ROLL

Cable Ties & Accessories

Slimlines - 18 lb Tensile Strength

	Width	Tensile Strength	Clear Part Number	Black Part Number	Blue Part Number
4	.100	18	20564	20564B	20564 Blue
5.5	.100	18	20561	20561B	
8	.100	18	20565	20565B	

Intermediate - 40 lb Tensile Strength

5.5	.140	40	20562	20562B	20562 Blue
8.5	.140	40	20563	20563B	

Standard - 50 lb Tensile Strength

7	.190	50	20568	20568B	20568 Blue
11	.190	50	20566	20566B	20566 Blue
14.5	.190	50	20567	20567B	20567 Blue

Heavy Duty - 120 - 175 lb Tensile Strength

14.5	.300	120	20567X	20567XB	
24	.350	175	20559X	20559XB	
36	.350	175	20560X	20560XB	

NEW

Mount Head - 50 lb Tensile Strength

7.5	.190	50	20557	20557B	
-----	------	----	-------	--------	--

Releasable Tie Kits

5990-245RC 100-20536 100-20537 10-20501-20502-20503-20504 5-20506
 5990-245RB 100-20536B 100-20537B 10-20501-20502-20503-20504 5-20506

NEW



Each compartment opens individually.

Releasable Ties

- Part Number: 20536 5" 50LB Release Clear
- Part Number: 20536B 5" 50LB Release Black
- Part Number: 20537 8" 50LB Release Clear
- Part Number: 20537B 8" 50LB Release Black
- Part Number: 20538 11" 50LB Release Clear
- Part Number: 20538B 11" 50LB Release Black
- Part Number: 20539 14" 50LB Release Clear
- Part Number: 20539B 14" 50LB Release Black

Cable Tie Cutter

Part Number
20710



Heavy Duty Cable Tie Tool

Part Number
20708

- Recommended use for 120-175 Lb. Wire Ties



Cable Tie Tool

Part Number 20609

- Automatically cuts excess cable ties flush
- Adjustable tension settings
- Recommended use for 18-50 Lb. Wire Ties



Adhesive Mount

Size	Color	Part Number
3/4 x 3/4	Clear	23060
3/4 x 3/4	Black	23060B
1 x 1	Clear	23061
1 x 1	Black	23061B



Nylon Clamps

Screw Size	Max Bundle	Part Number
8	.12	23427
8	.25	23429
8	.50	23434



Steel Cushioned Clamps

Screw Size	Max Bundle	Part Number
1/4	.250	23436
1/4	.375	23438
1/4	.500	23440
1/4	.625	23441
1/4	.750	23443
1/4	.875	23442
1/4	1.00	23444
1/4	1.25	23445



New More Sizes





**100 ft
ROLL**

GPT Primary Wire

	8 GA	10 GA	12 GA	14 GA	16 GA	18 GA	20 GA
Purple		54100	54120	54140	54160	54180	
Black	54081	54101	54121	54141	54161	54181	54201
Orange		54102	54122	54142	54162	54182	
Green		54103	54123	54143	54163	54183	
White	54084	54104	54124	54144	54164	54184	
Brown		54105	54125	54145	54165	54185	
Pink		54106	54126	54146	54166	54186	
Red	54087	54107	54127	54147	54167	54187	54207
Blue		54108	54128	54148	54168	54188	
Yellow		54109	54129	54149	54169	54189	
Gray		541010	541210	541410	541610	541810	

80°C 60 Volt PVC Insulation

500 ft. and 1,000 ft. spools available on request

Recommended Uses

- 10 GA For generator, heater switch, air conditioner, meter & panel lights
- 12 GA Light switches & ignition switches
- 14 GA Horn button circuit, head lights, gas gauge to coil & cigarette lighter
- 16 GA Header leads, gas gauge, directionals, stop signal & generator to starter
- 18 GA Single, bulb, low amp circuits & clock

Trailer Wire

Wire Size	2 Conductor Black-Red
14	53142
16	53162
18	53182

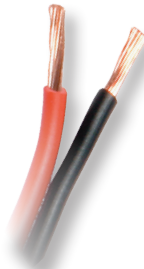

Jacketed Primary Wire

Wire Size	2 Conductor Black-White
8	55082
10	55102
12	55122
14	55142
16	55162



Trailer Wire

Wire Size	3 Conductor Brown-Green-Yellow
14	53143
16	53163
18	53183

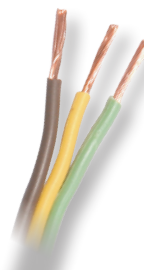

Jacketed Primary Wire

Wire Size	3 Conductor Black-Green-White
10	55103
12	55123
14	55143
16	55163

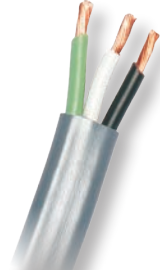

Trailer Wire

Wire Size	4 Conductor Brown-Green Yellow-White
14	53144
16	53164
18	53184

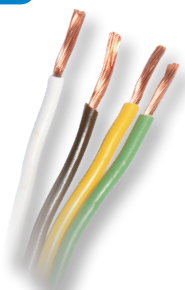

Jacketed Primary Wire

Wire Size	4 Conductor Black-Green Red-White
10	55104
12	55124
14	55144
16	55164

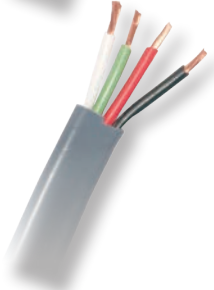

Recommended for RVs, boats and utility trailers.

Recommended for auto, truck, agriculture, construction and light marine applications. Heavy Duty flat PVC outer jacket is abrasion resistant and protects against moisture, oil, acid & salt.

Screw on Connectors

Finger Grip Connectors

Rated to 105°C (221°F) 600 volt max

Wire Size	Min.	Max	Part Number
-----------	------	-----	-------------

18-10	2 #18	3 #12	20584
-------	-------	-------	-------



18-8	3 #16	5 #12	20586
------	-------	-------	-------



18-8	3 #14 w/1 #18	3 #10	20588
------	------------------	-------	-------



14-6	2 #10 w/1 #12	1 #8 w/3 #10	20589
------	------------------	-----------------	-------



For a wider range of coverage

22-8	3 #22	4 #12	20509
------	-------	-------	-------



Performance Plus Connectors

Rated 105°C (221°F) 300/600 Volt Max.
Replaces eight standard connectors

22-12	2 #22	2 #12	20540
-------	-------	-------	-------



18-8	2 #18	2 #8	20541
------	-------	------	-------



14-8	4 #14	5 #12	20542
------	-------	-------	-------



Screw On Connectors

Rated 105°C (221°F) 300/600 Volt Max.

Wire Size	Min.	Max	Part Number
-----------	------	-----	-------------

22-14	2 #22	1 #16 w/1 #18	20501
-------	-------	---------------	-------



22-14	2 #22	3 #16	20502
-------	-------	-------	-------



22-14	1 #18 w/ 1 #20	4 #16 w/ 1 #20	20503
-------	----------------	----------------	-------



22-10	3 #20	2 #12 w/ 2 #14	20504
-------	-------	----------------	-------



22-10	3 #18	2 #20 w/2 #12	20506
-------	-------	---------------	-------



Ceramic Connectors

Rated 1000°F Max. 600 V

22-14	1 #14 w/ 1 #16	2 #14	20543
-------	----------------	-------	-------

22-10	3 #14	2 #10	20544
-------	-------	-------	-------



18-8	3 #14 w/ 3 #16	2 #8	20545
------	----------------	------	-------

Winged Grounding Connector

Color coded GREEN for quick identification as a grounding conductor for copper wire only.
Rated to 105°C (221°F) 1000 volt max

14-10	2 #14	5 #12	20583
-------	-------	-------	-------



W/P Connector Kits

Part Number: 5990-34
34 pc. Aqua W/P Connector Kit

20580 - 20 pc.
20581 - 10 pc.
20582 - 4 pc.

Purchase Individually

20580 22-12 Orange W/P Connector
20581 22-8 Red W/P Connector
20582 14-6 Blue W/P Connector



Instant Tap Connectors

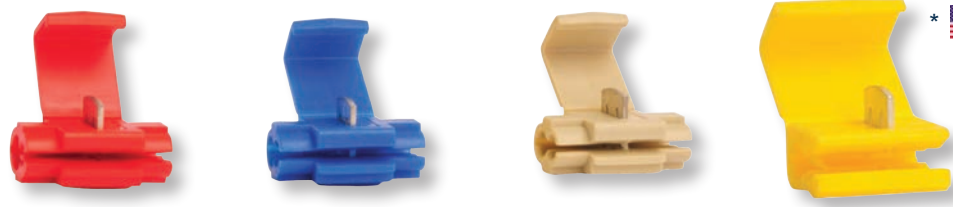

* Made in U.S.A

Rated 105°C 600 volts

20510
20510UL
22-16 with stop

20500
20500UL
18-14 with stop

20512
20512UL
18-14 no stop

20511
20511UL
12-10 with stop



WITH WIRE STOP



WITH NO WIRE STOP

T-Tap Connectors



Rated 105°C 600 volts

20513
24-20

20514
20514UL
22-16

20515
20515UL
16-14

20516
20516UL
12-10

**Double
Blades**
**NEW
Items**

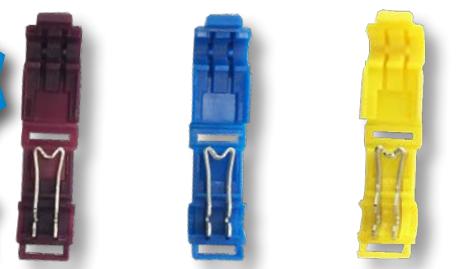

Rated 105°C 600 volts

20514DB
22-16

20515DB
16-14

20516DB
12-10



IDC Connectors

Wire Size	Description	Part Number
22-14	Blue w/ Gel	20518
22-14	Clear	20519
22-16	Black w/Gel	20520



Misc. Connectors

**NEW
Item**

Wire Size	Description	Part Number
18-14 / 12-10	Brown Dual Tap	20521
22-16 / 12-10	Red Dual Tap	20555
18-16	Blue Tap w/ Gel	20522
18-16	Bullet Style Tap	20523
18-16	Auto Fuse Holder	20524

Tap Connectors

Fuses & Fuse Holders

Micro Fuse Low Profile

NEW Item

Amp	Color	Part Number
5	Tan	63205
7	Brown	63207
10	Red	63210
15	Blue	63215
20	Yellow	63220
25	Clear	63225
30	Green	63230



Mini Fuse

2	Gray	63002
3	Violet	63003
4	Pink	63004
5	Tan	63005
7.5	Brown	63007
10	Red	63010
15	Blue	63015
20	Yellow	63020
25	Clear	63025
30	Green	63030



Standard Fuse

3	Violet	63103
4	Pink	63104
5	Tan	63105
7.5	Brown	63107
10	Red	63110
15	Blue	63115
20	Yellow	63120
25	Clear	63125
30	Green	63130
35	Purple	63135
40	Orange	63140



Maxi Fuse

20	Yellow	63420
30	Green	63430
40	Orange	63440
50	Red	63450
60	Blue	63460
70	Brown	63470
80	Clear	63480
100	Violet	63490

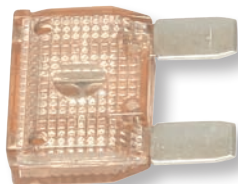

Mini Fuse Holder w/ 12" wire

Wire Range	Part Number
12GA - Rated to 30 Amp	90012
14GA - Rated to 20 Amp	90014
16GA - Rated to 10 Amp	90016
18GA - Rated to 5 Amp	90018



Standard Holder w/ 8" wire

10GA - Rated to 40 Amp	90110
12GA - Rated to 30 Amp	90112
14GA - Rated to 20 Amp	90114
16GA - Rated to 10 Amp	90116
18GA - Rated to 5 Amp	90118



Standard Holder w/ 12" wire

10GA - Rated to 40 Amp	90210
12GA - Rated to 30 Amp	90212
14GA - Rated to 20 Amp	90214
16GA - Rated to 10 Amp	90216
18GA - Rated to 5 Amp	90218



Standard Holder w/ 12" wire

12GA - Rated to 30 Amp	90312
14GA - Rated to 20 Amp	90314
16GA - Rated to 10 Amp	90316
18GA - Rated to 5 Amp	90318



Maxi Fuse Holder w/ 12" wire

8GA - Rated to 60 Amp	90408
10GA - Rated to 40 Amp	90410



Add-A-Circuit

NEW Item

Mini Fuse	90515
Standard Fuse	90516



Fuse Puller

Length Part Number

1.3" 90500
For Mini, Standard & Maxi Fuses

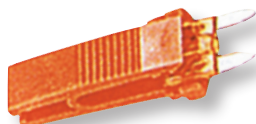

Length Part Number

2" 90600
For Mini, Standard, Maxi Fuses & Glass Fuses

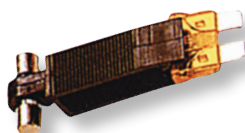

Length Part Number

4.1" 90700
For Mini, Standard, Maxi Fuses & Glass Fuses



Clips, Split Loom & Spiral Wrap

Alligator Clip w/ Vinyl Boot

Length	Max Opening	Color	Part Number
1 1/4"	1/4"	Red	AC31R
1 3/8"	5/16"	Red	AC35R
1 5/8"	7/16"	Red	AC41R
2"	7/16"	Red	AC50R



Charging Clips

Length	Max Opening		Color	Part Number
2 1/16"	19/32"	10 AMP	Red	CC10R
2 1/2"	3/4"	20 AMP	Red	CC20R
2 3/4"	7/8"	30 AMP	Red	CC30R
4 1/8"	1 1/2"	50 AMP	Red	CC50R



Length	Max Opening	Color	Part Number
1 1/4"	1/4"	Black	AC31B
1 3/8"	5/16"	Black	AC35B
1 5/8"	7/16"	Black	AC41B
2"	7/16"	Black	AC50B



Length	Max Opening		Color	Part Number
2 1/16"	19/32"	10 AMP	Black	CC10B
2 1/2"	3/4"	20 AMP	Black	CC20B
2 3/4"	7/8"	30 AMP	Black	CC30B
4 1/8"	1 1/2"	50 AMP	Black	CC50B



Split Loom

I.D. Size	Par Number
1/4" X 100 ft.	56014
1/4" X 500 ft.	56014-5C
1/4" X 1000 ft.	56014-1M
3/8" X 100 ft.	56038
3/8" X 500 ft.	56038-5C
3/8" X 1000 ft.	56038-1M
1/2" X 100 ft.	56050
1/2" X 500 ft.	56050-5C
1/2" X 1000 ft.	56050-1M
3/4" X 100 ft.	56075
3/4" X 500 ft.	56075-5C
3/4" X 1000 ft.	56075-1M

- Provides a Neat Appearance
- Insulates and Protects Wire
- Easy Insulation
- Polyethylene
- -40° to +185° F

Split Loom offered in 100 ft, 500 ft, and 1,000 ft.

1000 ft Length

500 ft Length

100 ft Length



Spiral Wrap

I.D. Size	Part Number
1/8"	57012
1/4"	57025
3/8"	57038
1/2"	57050
3/4"	57075
1"	57100

- Insulates and Protects Wire
- Bundle Multiple Wires For A Neat Installation
- Wires Can Be Fed Through The Wrap To Different Locations

100 ft SPOOL

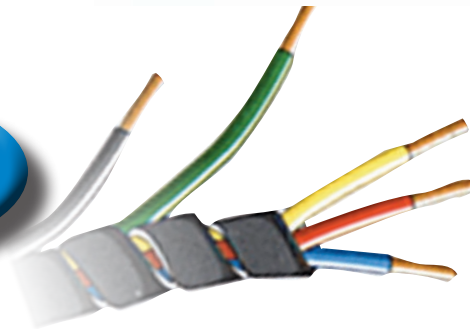

Cutting Tools

Part Number	Description
20774	Cutting Tool for Loom & Wrap
10774	Replacement Blade



Accessories

Accessories

Part Number	Description
73181	Solder - 16 oz. spool, 1/8" dia. 40/60 tin/lead
73183	Solder Flux - 4 oz. zinc chloride solder paste flux
73185	Quick Flux - Cleans and prepares surface
73187	Dielectric Grease - 5oz. Tube
73191	Brush On Electrical Tape - 4oz. brush top can
73188	Dielectric Grease - 2 gram pillow pack

Solder Pellets

Pre-measured solder pellets ensure the right amount of solder for each connection

Part Number	Wire Size	Color Stripe
SP-6	6 GA	Grey
SP-4	4 GA	Grey
SP-2	2 GA	Green
SP-1	1 GA	Pink
SP-1-0	1/0	Black
SP-2-0	2/0	Orange
SP-3-0	3/0	Purple
SP-4-0	4/0	Yellow



Miscellaneous Tools

Wire Stripper

Wire Size	Length	Lbs.	Part Number
26-10	8"	.66#	20604



Cable Cutter

Wire Size	Length	Lbs.	Part Number
20-4/0	8"	.66#	20605



Cutter/Stripper

Wire Size	Length	Lbs.	Part Number
24-12	5"	.16#	20607



QuickStrip Cable Stripper

Part Number	Features
20706	<ul style="list-style-type: none"> • Strips up to 4/0 gauge • Includes spare blade • Only 5 1/2" long



Ratchet Controlled

Gives the same results whenever you use them



20591*
Non-Insulated 22-8 ga.
Length 10.8" Lbs. 1#



20592*
Insulated 22-14 ga.
Length 9.7" Lbs. 1.1#



20593*
Insulated 12-10 ga.
Length 12.8" Lbs. 2.02#



20594
Insulated 22-18 & 16-14
Flags Part # 20188 & 20189



20595
Insulated 22-10 Female QDC
Length 8.875" Lbs. 1.2#



20700
Insulated 22-10 ga. Female
Length 9" Lbs. 1.2#



20608Y (yellow)
20608R (red)
Insulated 22-10 ga.
Length 9.5" Lbs. 1.27#



TR-490
Insulated & Non-Insulated 22-10 ga.
Nylon, Vinyl, Butted, or Brazed



20704 Insulated Flag 16-10 ga. 20705 Insulated Flag 22-14 ga. 20713 Non-Insulated Flag 22-14 ga.



20709 Closed End Connectors 22-10 ga.

* UL & CSA listed tools with Hillsdale's Terminals

Hand Crimpers



20600
Upfront Stripper
22-10 ga.
Length 9.25" Lbs. 1.3#

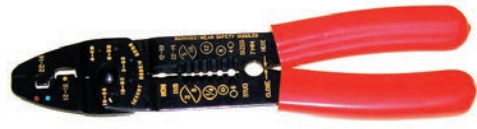

20601
Upfront Crimper
22-10 ga.
Length 8.25" Lbs. .72#

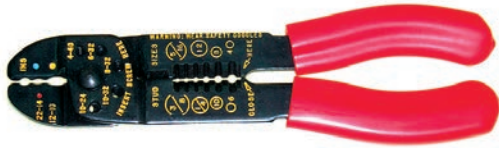

20602
Snub Nose Crimper
22-10 ga.
Length 7.5" Lbs. .66#



20716
Multi-Function Crimping Tool
Cuts/Strips/Crimps
22-10 ga.
Non and Insulated Terminals, Flag Terminals, Bolts,
W/ Pliar Tip and Spring Loaded Handle
Length 8-5/8"

**NEW
Item**



20597
Crimper
22-10 ga.
Length 9" Lbs. .7#



20603
Econo Crimper
22-10 ga.
Length 7.5" Lbs. .66#

Heat Shrink Torches & Tools



20606
Mini Torch
Refillable Lighter
Electronic Igniter



20590
Butane Torch
Interchangeable Tips
120 min. of operation



20596
Heat Shrink Insulated
Ratchet Controlled Crimper
20-8 ga.
Length 11" Lbs. 1.2#

**NEW
Item**



20715
Heat Shrink Butt Connectors
Ratchet Controlled Crimper
22-8 ga.
Length 9" Lbs. 1.2#

HexCrimp Sr.™

- Part Number 20701
- Hand-held 26" overall length
 - Crimps all major brands of connectors
 - 8 GA - 250 mcm
 - Made in USA



HexCrimp Jr.™

- Part Number 20702
- Designed for medium and heavy duty - crimps 10 thru 1 gauge cable
 - Ideal for working under the hood or in tight spots - 19 inch overall length
 - Smaller size easier to store in tool box

Quick Cutter 2™

- Part Number 20703
- Cuts cable up to 250 MCM (6/0GA)
 - 22" handles for easier cutting
 - Blades made of 1075 carbon steel, heat treated for long life can be resharpened
 - Made in USA



The Crimp Master

- Part Number 20599
- 24" Length
 - Crimps 8 - 4/0
 - Triangular crimp
 - Made in USA



Brute Hammer Crimper

- Part Number 20707
- Inexpensive, simple crimping tool
 - Use with hammer or vise
 - Crimps 8 thru 4/0 gauge connectors
 - Spring loaded pin locks in "up" position for loading connector and cable, when released pin holds connector securely during crimping



Electrical Tape and Silicone Wrap

Vinyl Electrical Tape

Length	Description		Part Number
3/4 x 60'	Black	7.5 mil	TAPE-BK
3/4 x 60'	Blue	7.5 mil	TAPE-BL
3/4 x 60'	Green	7.5 mil	TAPE-GN
3/4 x 60'	Orange	7.5 mil	TAPE-OR
3/4 x 60'	Red	7.5 mil	TAPE-RD
3/4 x 60'	White	7.5 mil	TAPE-WH
3/4 x 60'	Yellow	7.5 mil	TAPE-YL
3/4 x 60'	Brown	7.5 mil	TAPE-BR
3/4 x 66'	3M Super 33	7 mil	TAPE-33
3/4 x 66'	3M Super 88	8.5 mil	TAPE-88



NEW

Self Fusing Silicone Wrap

Use this flexible self-fusing silicone rubber tape to insulate, protect and seal anything you can wrap.

Bonds to Itself on Contact | Uses No Adhesives | Waterproof | Extreme Temperature Range (-65 °F up to 500 °F)
Leaves No Residue | Ultra Resistant to UV, oil, salt, and corrosive chemicals | No Special Tools Required

Length	Description		Part Number
1' x 10'	Red	20 mil	SWTAPE-RD
1" x 10'	Blue	20 mil	SWTAPE-BL
1" x 10'	Yellow	20 mil	SWTAPE-YL
1" x 10'	Black	20 mil	SWTAPE-BK
1" x 10'	Clear	20 mil	SWTAPE-CR
2" x 36'	Grey (Industrial Use)	30 mil	SWTAPE-GY

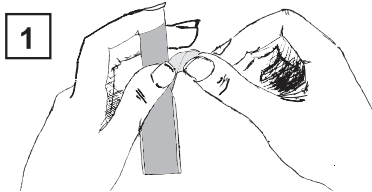

1 Begin by peeling liner away from silicone tape

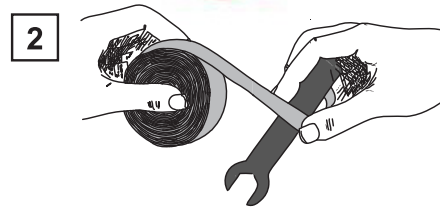

2 Press tape firmly on object being wrapped, hold in place and begin first wrap completely over itself

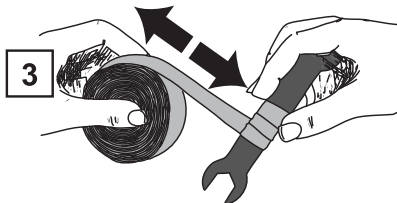

3 While holding tape in place, begin **STRETCHING** at 2 to 3 times it's length and wrap object with a 2/3 overlap to ensure a proper seal

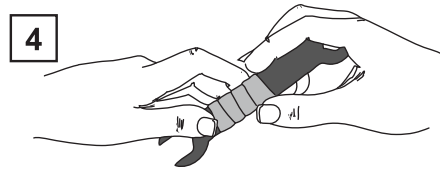

4 To complete wrapping of object, wrap tape completely over previous layer and press firmly

* To ensure proper application, remember to completely overlap tape at the beginning and on the final wrap



The MCTM-101

Our mylar tape fed products are universally spaced and can be applied with the MTCM - 101 and other standard electric applications.

The MTCM - 101 is heavy duty, durable and simple to operate. Powered by 85-100 PSI air pressure and 110 VAC. Fully automatic and foot actuated.

The machine comes with three sets of dies. One set for each size: 22-18, 16-14 and 12-10 gauge. Each die crimps bare, vinyl, and heat shrink.

Machine Specifications:

Weight 70 Lbs.

Air: 1/4" NPT Inlet

Stroke Rate: 1000 SPH

Foot Pedal: Momentary switch. 5ft. cord

Dimensions: 12" Wide - 20" Deep - 17"

Height Electrical: 110V 5 ft. grounded standard plug

Reel Size: 14" outside dia reel with 3/4" core

Built in counter

Operates with PLC programmable controller

Buzzer to alert operator of machine malfunction

Index feature for single or double spaced terminals



- Most rings, spades and butt connectors can be ordered by adding "MT" as a suffix. Call customer service with questions.

Wire Processing

Call about our wire processing capabilities. We have added cutting and stripping abilities to go along with the crimp machine. Let us cut and strip your wires, cutting to length, full or partial strip and window stripping available for low runs. Simple harnesses, using Hillsdale connectors can now be done in house.

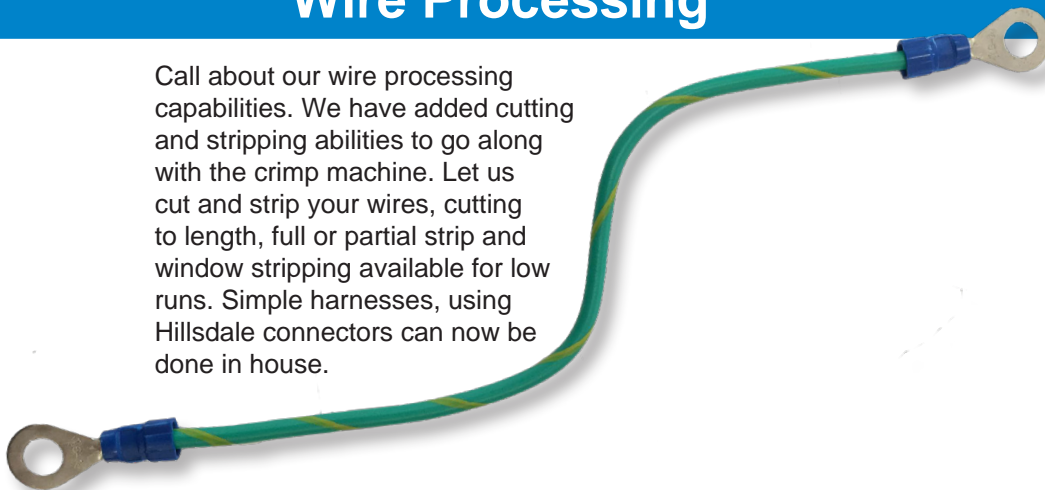

Boxed Kits



65 PC Heat Shrink Assortment
Part # 5990-65 7 x 3.5"

- 10 pcs. - 16-14 & 22-18 Butt Splice
- 5 pcs. - 12-10 Butt Splice
- 5 pcs. - 22-18, 16-14 & 12-10 Ring 10
- 5 pcs. - 22-18, 16-14 & 12-10 Spade 10
- 5 pcs. - 16-14 .250 QDC M/F



140 PC Heat Shrink Butt Connector Kit
Part # 5990-140 8 x 4.5"

- 50 pcs. - 22-18 butt
- 75 pcs. - 16-14 butt
- 15 pcs. - 12-10 butt



68 PC Heat Shrink Tubing Kit
Part # 5990-68 8 x 4.5"

- 20 pcs. - Red 3/16" x 1.5"
- 20 pcs. - Blue 1/4" x 1.5"
- 10 pcs. - Yellow 5/16" x 1.625"
- 10 pcs. - Red 3/8" x 1.875"
- 5 pcs. - Black 3/8" x 2"
- 3 pcs. - Black 1/2" x 3"



38 PC Heat Shrink Tubing Kit
Part # 5990-38 11 x 6.5"

- 10 pcs. - Red 3/16"
- 10 pcs. - Blue 1/4"
- 5 pcs. - Yellow 5/16"
- 5 pcs. - Black 3/8"
- 5 pcs. - Black 1/2"
- 3 pcs. - Black 3/4"



18 x 12"



9 x 13"

480 PC Assortment Kit
Vinyl or Heat Shrink
Part # 5990-480VP = Vinyl Plastic Kit
Part # 5990-480VM = Vinyl Metal Kit
Part # 5990-480HSP = Heat Shrink Plastic Kit
Part # 5990-480HSM = Heat Shrink Metal Kit

- 20 pcs. - 22-18, 16-14 & 12-10 Butt
- 20 pcs. - 22-18, 16-14 & 12-10 Spades #10
- 20 pcs. - 22-18 Rings #10, 1/4, 5/16 & 3/8
- 20 pcs. - 16-14 Spades #10, 1/4, 5/16 & 3/8
- 20 pcs. - 12-10 Rings #10, 1/4, 5/16 & 3/8
- 20 pcs. - 22-18, 16-14 & 12-10 .250 QDC M/F



706 PC Heat Shrink Kit w/ Ratchet Tool
Part # 5990-706 18.5" x 12"

- 50 pcs. - 22-18 & 16-14 butt
- 30 pcs. - 12-10 butt
- 15 pcs. - 8 ga. butt
- 10 pcs. - Rings 22-18, 16-14, 12-10, Stud Sizes 6, 8, 10, 1/4, 5/16, 3/8
- 15 pcs. - Rings 8 ga., #10, 3/8
- 10 pcs. - Spades 22-18, 16-14, 12-10, Stud Sizes 6, 8, 10
- 25 pcs. - QDC Male & Female .250, 22-18, 16-14, 12-10
- 15 pcs. - 16-14 Male & Female .157
- 10 pcs. - QDC Male & Female .250, Fully Insulated, 22-18, 16-14, 12-10
- 10 pcs. - Step Down butts, 16-14 to 22-18, 12-10 to 16-14
- 1 - Ratchet Tool
- 4 - Crimp Nest



190 PC Closed End Connector Kit
Part Number: 5990-190

- 20569 - 100 pc.
- 20570 - 60 pc.
- 20571 - 20 pc.
- 20572 - 10 pc.



76 PC Closed End Connector Kit
Part Number: 5990-76

- 20569 - 40 pc.
- 20570 - 20pc.
- 20571 - 10 pc.
- 20572 - 6 pc.



Boxed Kits



100 PC Mini Fuse Kit
Part # 5990-100 7 x 3.5"

- 20 pcs. - 10 amp
- 10 pcs. - 3, 4, 5, 7.5, 15, 20, 25 & 30 amp



60 PC Standard Fuse Kit
Part # 5990-60 7 x 3.5"

- 10 pcs. - 25 amp
- 5 pcs. - 3, 4, 5, 7.5, 10, 15, 20, 30, 35 and 40 amp



20 PC Maxi Fuse Kit
Part # 5990-20 7 x 3.5"

- 2 pcs. - 30, 70, 80 & 100 amp
- 4 pcs. - 40, 50 & 60 amp



130 PC Micro Fuse Low Profile Kit
Part # 5990-130

- 10 pcs. - 5 & 7.5 amp
- 20 pcs. - 10, 15, 25 & 30 amp
- 30 pcs. - 20 amp



55 PC Instant Tap Connector Kit
Part # 5990-55 8 x 4.5"

- 10 pcs. - 22-18 Red
- 25 pcs. - 18-14 Blue
- 10 pcs. - 18-14 White
- 10 pcs. - 12-10 Yellow



120 PC Screw On Connector Kit
Part # 5990-120 8 x 4.5"

- 40 pcs. - 22-16 Grey
- 30 pcs. - 22-14 Blue
- 20 pcs. - 22-14 Orange
- 15 pcs. - 18-12 Yellow
- 10 pcs. - 18-10 Red
- 5 pcs. - 14-8 Grey



180 PC Solderless Quick Connector Kit
Part # 5990-180 11 x 6.5"

- 10 pcs. ea. of the following:
- 22-18 & 16-14 .250 N/I Flag
- 22-18 & 16-14 .250 V/I Male
- 22-18 & 16-14 .110, .187, .205 & .250 V/I Female
- 22-18 & 16-14 .250 Fully Insulated Male & Female
- 12-10 .250 V/I Male & Female

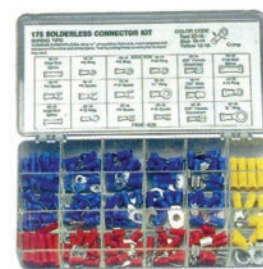

175 PC Assortment Kit
Part # 5990-175N = Nylon
Part # 5990-175V = Vinyl
11 x 6.5"

- 4 pcs. - 12-10 Butt Splice
- 11 pcs. - 16-14 Butt Splice
- 11 pcs. - 22-18 Butt Splice
- 4 pcs. - 12-10 Rings #10 & 3/8
- 11 pcs. - 16-14 Rings #6, #8 & #10
- 9 pcs. - 16-14 Ring 1/4
- 11 pcs. - 16-14 Spades #6, #8 & #10
- 11 pcs. - 16-14 .250 QDC Male & Female
- 11 pcs. - 22-18 Ring #10
- 11 pcs. - 22-18 Spades #6 & #10
- 11 pcs. - 22-18 .250 QDC Female



240 PC Terminal Kit with Tool
Part # 5990-240N = Nylon
Part # 5990-240V = Vinyl
11 x 6.5"

- 1 pc. - Economy Crimper
- 20 pcs. - 12-10 Butt Splice
- 20 pcs. - 16-14 Butt Splice
- 20 pcs. - 22-18 Butt Splice
- 10 pcs. - 12-10 Rings #8, #10, 5/16 & 3/8
- 10 pcs. - 12-10 Spades #6 & #10
- 10 pcs. - 16-14 Rings #6 & #10
- 10 pcs. - 16-14 Spades #6 & #10
- 10 pcs. - 16-14 .250 QDC Male & Female
- 10 pcs. - 22-18 Rings #6 & #10
- 10 pcs. - 22-18 Spades #6 & #10
- 10 pcs. - 22-18 .250 QDC Male & Female



2400 PC Starter Kit
Part # 5990-2400N = Nylon
Part # 5990-2400V = Vinyl
Metal Box 18.5 x 12"

- 100 pcs. - 22-18 Rings, Stud Size #8, 10, 1/4, 5/16
- 100 pcs. - 16-14 Rings #10, 1/4, 5/16, 3/8
- 100 pcs. - 12-10 Rings #10, 1/4, 5/16, 3/8
- 100 pcs. - 22-18, 16-14, 12-10 Butt
- 100 pcs. - 22-18, 16-14, 12-10 Spade #10
- 100 pcs. - 22-18, 16-14, 12-10 Male 1/4
- 100 pcs. - 22-18, 16-14, 12-10 Female 1/4



170 PC Butt Connector Kit
Part # 5990-170 7 x 3.5"

- 25 pcs. - 12-10 Vinyl & Nylon
- 30 pcs. - 16-14 Vinyl & Nylon
- 30 pcs. - 22-18 Vinyl & Nylon



- ***UL & CSA LISTED PARTS***
- ***AMERICAN MADE***
- ***COMPETITIVE PRICING***
- ***IMMEDIATE SHIPPING***
- ***FULL LINE OF PRODUCTS***

TO ORDER CALL:

Phone: 1-800-447-3150

FAX: 517-437-0797

e-mail: sales@hillsdaleterminal.com

HILLSDALE TERMINAL

250 Industrial Drive
Hillsdale, MI 49242
www.hillsdaleterminal.com

1-800-447-3150

FAX: 517-437-0797

HOURS:

Monday - Friday

8:00 a.m. - 4:30 p.m. E.S.T.

Please have part numbers and quantities ready before you call.

TERMS:

\$25.00 minimum on all orders.

Mastercard, VISA and American Express are accepted.