

HEX – IMPERIAL

DESCRIPTION

Hex key stock is a stock of material that is one foot or greater in length from which hex machine keys are made. This stock has a hexagonal profile. Hex size is measured across parallel flats.

HOW TO IDENTIFY

1. Measure hex across the flats (A).
2. Measure length (C).
3. Build the part number from the chart on the next page.

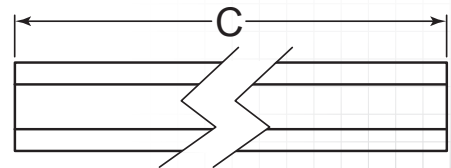
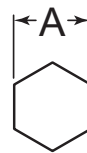
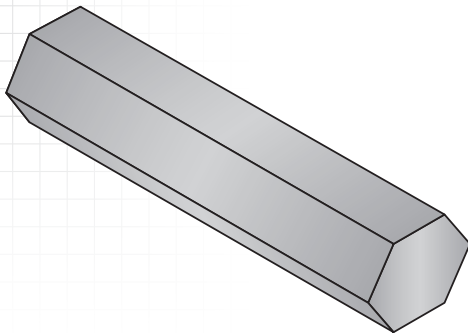

PREFIX MATERIAL/FINISH

HEX = COLD FINISHED STEEL, PLAIN*
HEX40 = COLD FINISHED ALLOY STEEL, PLAIN* (4140)
HEXB = BRASS, PLAIN
 Material/finish combinations may not be available in all sizes.



THE PRIMARY BENEFIT OF USING HEX KEY STOCK FOR SHAFTING IS THAT IT DOES NOT REQUIRE A KEY WAY OR MACHINE KEY

HEX (A) TOLERANCES

MATERIAL	HEX
(Prefix)	(Material/Finish)
(Size Range)	(Tolerance)
HEX	Cold Finished Steel, Plain*
.1250 – .7500"	+0/-.0020"
>.7500 – 1.500"	+0/-.0030"
>1.5000 – 2.5000"	+0/-.0040"
>2.5000 – 4.0000"	+0/-.0050"
HEX40	Cold Finished Alloy Steel, Plain* (4140)
.1250 – .7500"	+0/-.0030"
>.7500 – 1.500"	+0/-.0040"
>1.5000 – 2.5000"	+0/-.0050"
>2.5000 – 4.0000"	+0/-.0060"
HEXB	Brass, Plain
.1250"	±.0025"
>.1250 – .5000"	±.0030"
>.5000 – 1.0000"	±.0040"
>1.0000 – 2.0000"	±.0050"
>2.0000 – 2.1250"	±.0060"
>2.1250 – 2.3750"	±.0070"
>2.3750 – 2.7500"	±.0080"
>2.7500 – 3.2500"	±.0090"
>3.2500 – 3.5000"	±.0110"
>3.5000 – 4.0000"	±.0120"

LENGTH (C) TOLERANCES

LENGTH	TOLERANCE
12 – 36"	+0/-.125"
>36 – <144"	+0/-.250"
144"	±6"

Nonstandard lengths up to 144" are available. Lengths over 3' may be subject to a packaging charge.

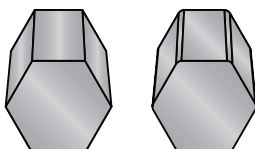

FITTING HEX KEY STOCK TO HEX BEARINGS OR HUBS CAN BE CHALLENGING, OFTEN TIMES TURNING HEX STOCK ON A LATHE TO SLIGHTLY ROUND SHARP CORNERS WILL HELP EASE FIT

HEX KEY STOCK CAN BE PRODUCED IN MANY HEX SIZE AND LENGTH COMBINATIONS

FOR DETAILED SPECIFICATIONS AND TOLERANCES, VISIT HUYETT.COM.

Prices, materials, dimensions, tolerances, designs, and grades subject to change without notice. © 2016 G.L. Huyett

*Limited warranty for surface finish: 30 days from date of shipment. See page 12 for details.

HEX – IMPERIAL

ZINC PLATING AND
OTHER FINISHES
AVAILABLE FOR
ALL PARTS
SEE PAGE 16

HOW TO BUILD A PART NUMBER

HEX-0562-144

ITEM PREFIX

HEX-

TO ORDER CHOOSE
YOUR MATERIAL,

CODE	MATERIAL
HEX-	Cold Finished Steel, Plain*
HEX40-	Cold Finished Alloy Steel, Plain* (4140)
HEXB-	Brass, Plain

METRIC HEX KEY
STOCK IS AVAILABLE
AS A SPECIAL ORDER
CONTACT
SALES@HUYETT.COM OR
CALL 785-392-3017

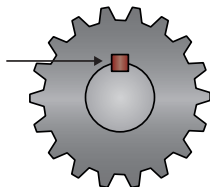
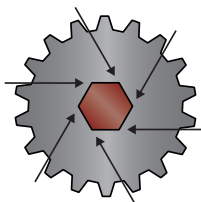

WHY CONSIDER USING HEX KEY STOCK INSTEAD OF SQUARE OR ROUND?

A hex shaft distributes the torque load across six points of contact (the six corners of the hex shaft) as opposed to concentrated points of a key way.

(A) HEX

1/8" to 3"

0562

CHOOSE YOUR
HEX SIZE,

CODE	HEX
0125	.1250" (1/8)
0187	.1875" (3/16)
0218	.2188" (7/32)
0250	.2500" (1/4)
0312	.3125" (5/16)
0375	.3750" (3/8)
0437	.4375" (7/16)
0500	.5000" (1/2)
0562	.5625" (9/16)
0625	.6250" (5/8)
0687	.6875" (11/16)
0750	.7500" (3/4)
0812	.8125" (13/16)
0875	.8750" (7/8)
0937	.9375" (15/16)
1000	1.0000" (1)
1062	1.0625" (1-1/16)
1125	1.1250" (1-1/8)
1187	1.1875" (1-3/16)
1250	1.2500" (1-1/4)
1312	1.3125" (1-5/16)
1375	1.3750" (1-3/8)
1437	1.4375" (1-7/16)
1500	1.5000" (1-1/2)
1625	1.6250" (1-5/8)
1750	1.7500" (1-3/4)
1812	1.8125" (1-13/16)
1875	1.8750" (1-7/8)
2000	2.0000" (2)
2062	2.0625" (2-1/16)
2250	2.2500" (2-1/4)
2500	2.5000" (2-1/2)
2750	2.7500" (2-3/4)
3000	3.0000" (3)

Additional sizes up to 7" available as a special order. Visit huyett.com for more details.

(C) LENGTH

12" to 144"

-144

CHOOSE YOUR
LENGTH.

CODE	LENGTH
-12	12" (1')
-24	24" (2')
-36	36" (3')
-48	48" (4')
-72	72" (6')
-120	120" (10')
-144	144" (12')

Nonstandard lengths up to 144" are available. Lengths over 3' may be subject to a packaging charge.

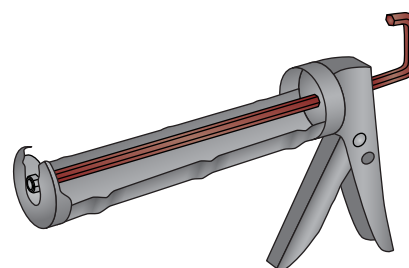

HEX KEY STOCK IS USED IN SIMPLE MACHINES LIKE THIS CAULKING GUN, OR IN SOPHISTICATED WORM GEAR, HELICAL GEAR, AND BEVEL GEAR SPEED REDUCTION BOXES

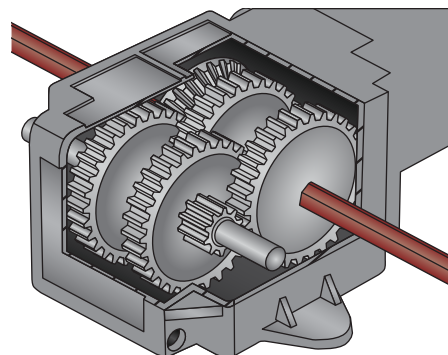

FOR DETAILED SPECIFICATIONS AND TOLERANCES, VISIT HUYETT.COM.

Prices, materials, dimensions, tolerances, designs, and grades subject to change without notice. © 2016 G.L. Huyett

*Limited warranty for surface finish: 30 days from date of shipment. See page 12 for details.