



SERVICE PARTS LIST

BULLETIN NO.
54-49-8555

SPECIFY CATALOG NO. AND SERIAL NO. WHEN ORDERING PARTS		REVISED BULLETIN	DATE
56" HIGH CAPACITY STEEL STORAGE CHEST & CABINET COMBO			Jan. 2019
CHEST CATALOG NO.	48-22-8557	SERIAL NUMBER	J83A
CABINET CATALOG NO.	48-22-8558	SERIAL NUMBER	J82A

WIRING INSTRUCTION

●14-46-1659
Hardware Kit

5	-----	Screw M6 x 12L	(4)
7	-----	Screw M4 x 12L	(8)
11	-----	Screw M4 x 12L	(8)
15	-----	Bolt M6 x 16L	(4)
18	-----	Screw M4 x 16L	(4)
21	-----	Bolt M6 x 16L	(4)
24	-----	Nut M6	(2)
25	-----	Washer	(2)
26	-----	Bolt M6 x 8.5L	(2)
33	-----	Bolt M8 x 18L	(16)
34	-----	Washer 19 x 8.5 x 2	(16)
39	-----	Screw M4 x 16L	(8)
44	-----	Screw M6 x 16L	(2)
47	-----	Screw M4 x 16L	(8)
51	-----	Bolt M6 x 16L	(2)
55	-----	Screw M6 x 12L	(4)
--	-----	Charger Mounting Screw M4 x 12L	(4)

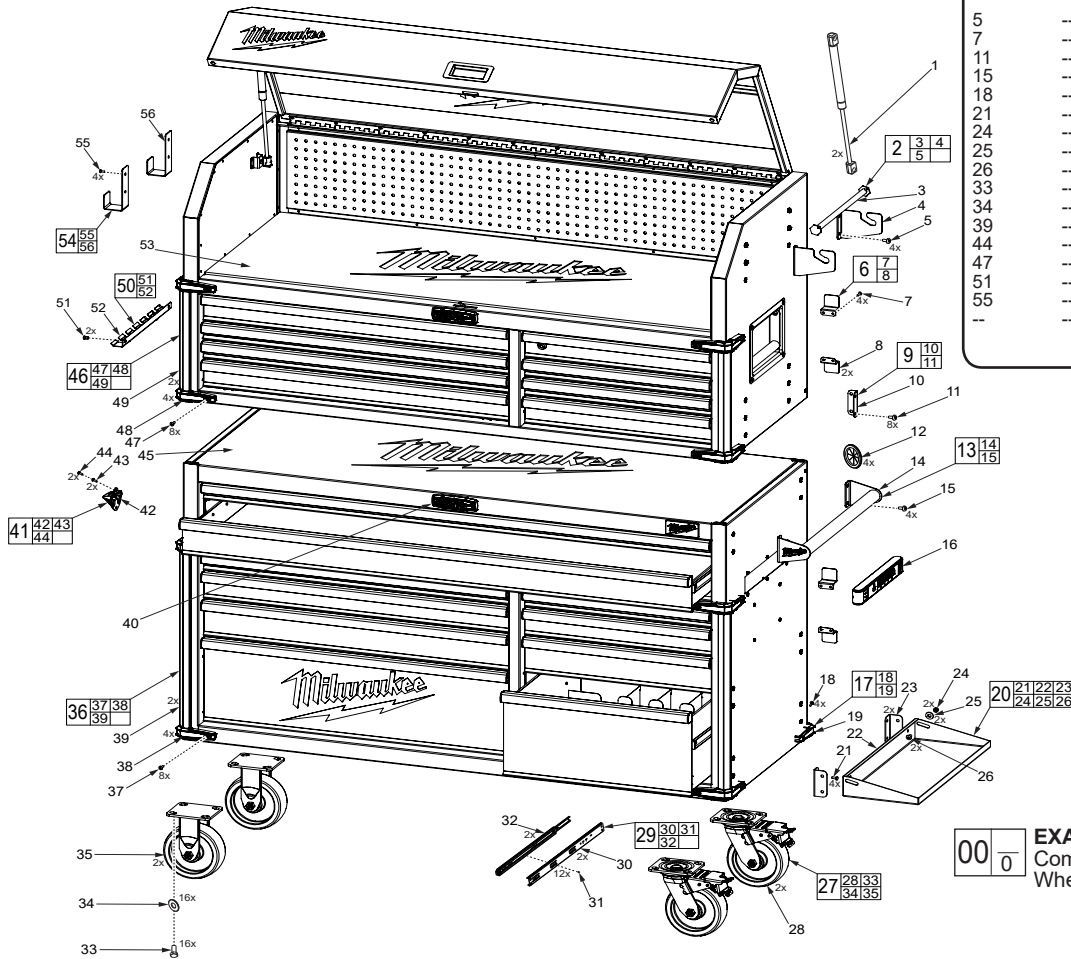

EXAMPLE:
Component Parts (Small #) Are Included When Ordering The Assembly (Large #).

NOTE: See page 2 for drawer slide removal and installation.

FIG.	PART NO.	DESCRIPTION OF PART	NO. REQ.	FIG.	PART NO.	DESCRIPTION OF PART	NO. REQ.
1	14-46-1661	Chest Lid Gas Lift (Set of 2)	(1)	34	-----	Washer 19 x 8.5 x 2	(16)
2	14-46-1653	Paper Towel Holder Kit	(1)	35	-----	Rigid Caster	(2)
3	-----	Paper Towel Holder Rod	(1)	36	42-38-0267	Cabinet Corner Bumper/Extrusion Kit	(1)
4	-----	Paper Towel Holder Bracket	(2)	37	-----	Corner Guard	(2)
5	-----	Screw M6 x 12L	(4)	38	-----	Corner Bumper	(4)
6	14-46-1645	Cord Storage Bracket Kit	(2)	39	-----	Screw M4 x 16L	(8)
7	-----	Screw M4 x 12L	(8)	40	14-46-1658	Digital Lock Kit (Set of 1)	(2)
8	-----	Cord Storage Bracket	(4)	41	48-22-8599	Bottle Opener Kit	(1)
9	14-46-1305	Bracket Kit (Set of 2)	(1)	42	-----	Bottle Opener	(1)
10	-----	Bracket	(2)	43	-----	Screw M6 x 20L	(2)
11	-----	Screw M4 x 12L	(8)	44	-----	Screw M6 x 16L	(2)
12	22-90-0105	Cord Grommet (Set of 4)	(1)	45	42-38-0157	Cabinet Mat	(1)
13	14-46-1648	Side Handle Kit	(1)	46	42-38-0266	Chest Corner Bumper/Extrusion Kit	(1)
14	-----	Side Handle	(1)	47	-----	Screw M4 x 16L	(8)
15	-----	Bolt M6 x 16L	(4)	48	-----	Corner Bumper	(4)
16	14-46-1641	Power Strip	(2)	49	-----	Corner Guard	(2)
17	42-38-0269	Rear Bumper Kit (Set of 2)	(1)	50	14-46-1625	Tool Storage Hanger Kit	(1)
18	-----	Screw M4 x 16L	(4)	51	-----	Bolt M6 x 16L	(2)
19	-----	Rear Bumper	(2)	52	-----	Tool Storage Hanger	(1)
20	14-46-1651	Storage Shelf Kit	(1)	53	42-38-0147	Chest Mat	(1)
21	-----	Bolt M6 x 16L	(4)	54	14-46-1652	Utility Hook Kit	(1)
22	-----	Storage Shelf	(1)	55	-----	Screw M6 x 12L	(4)
23	-----	Storage Shelf Bracket	(2)	56	-----	Utility Hook	(2)
24	-----	Nut M6	(2)	-----	-----	Chest Service Nameplate (Not Shown)	(1)
25	-----	Washer	(2)	-----	-----	Cabinet Service Nameplate (Not Shown)	(1)
26	-----	Bolt M6 x 8.5L	(2)	-----	-----	Electrical Label (Not Shown)	(1)
27	14-46-1649	Caster Kit (Set of 4)	(1)	-----	-----	Chest Drawer Liner Kit (Set of 8) (Not Shown)	(1)
28	-----	Swivel Caster with Brake	(2)	-----	-----	Cabinet Drawer Liner Kit (Set of 10) (Not Shown)	(1)
29	14-46-1662	Drawer Slide Kit (Set of 2)	(1)				
30	-----	Outer Drawer Slide	(2)				
31	-----	5/32" Pop Rivet	(12)				
32	-----	Inner Drawer Slide	(2)				
33	-----	Bolt M8 x 18L	(16)				

FIG. 16 NOTES
A second Power Strip is located on the inside of the top chest.

Cat. No. 48-22-8520 shown

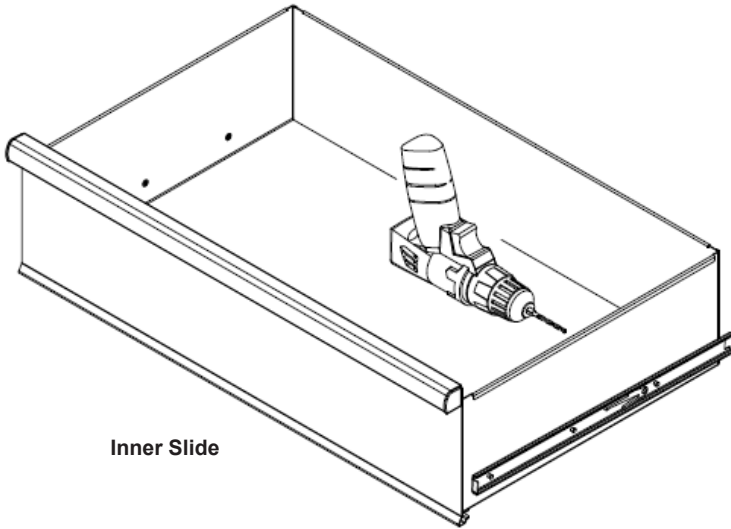

Inner Slide

To remove drawer slide, remove rivets (31) from the inner slide (32) and outer slide (30) by 5/32" drill bit.

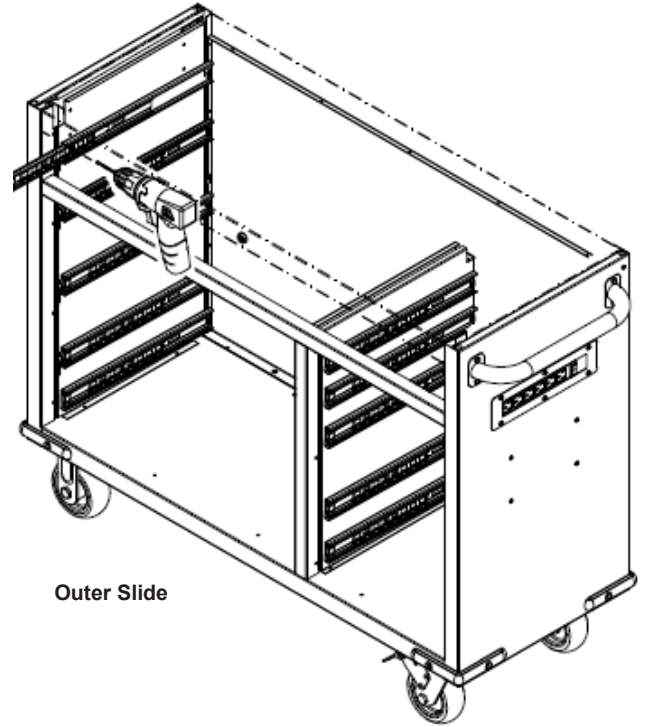

Outer Slide

To install drawer slide, place inner slide (32) into position and insert rivets (31) by using a rivet gun. Repeat steps for outer slide (30).

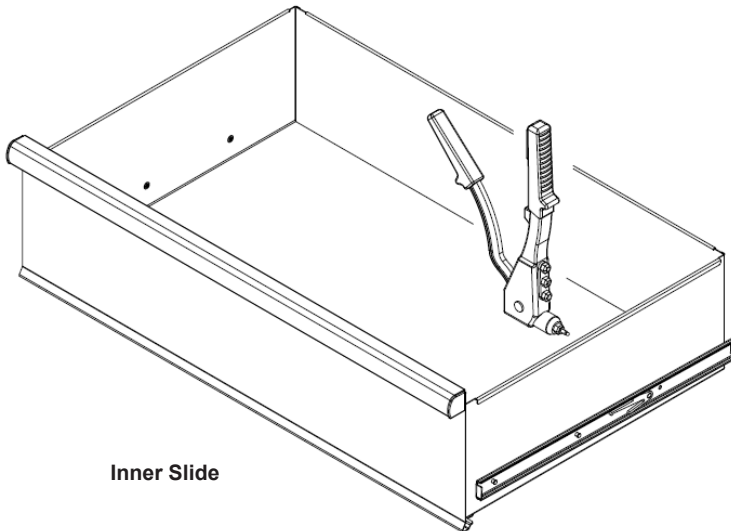

Inner Slide

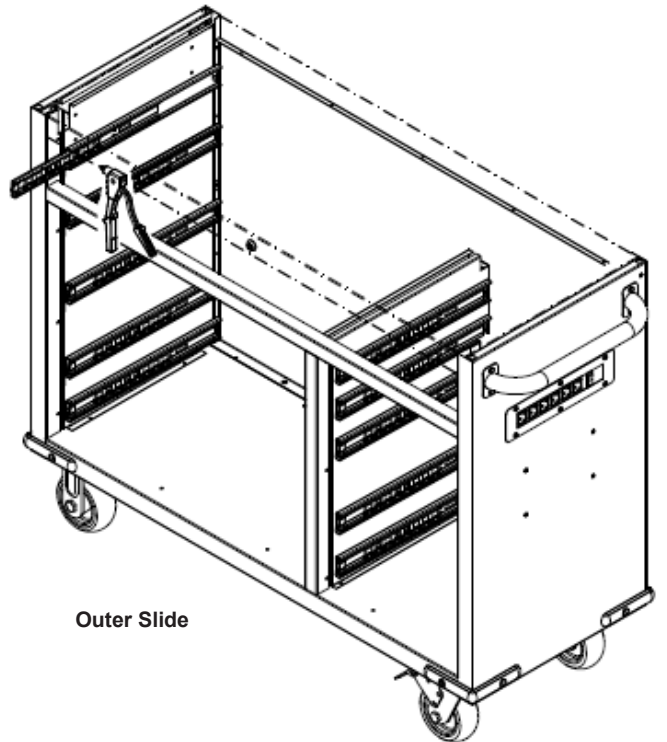

Outer Slide