



SERVICE PARTS LIST

BULLETIN NO.
54-07-3550

SPECIFY CATALOG NO. AND SERIAL NO. WHEN ORDERING PARTS		REVISED BULLETIN	DATE
72" Laser Tripod			June 2021
CATALOG NO. 48-35-1411	STARTING SERIAL NO.	WIRING INSTRUCTION	

EXAMPLE:

00	0
----	---

 Component Parts (Small #)
 Are Included When Ordering
 The Assembly (Large #).

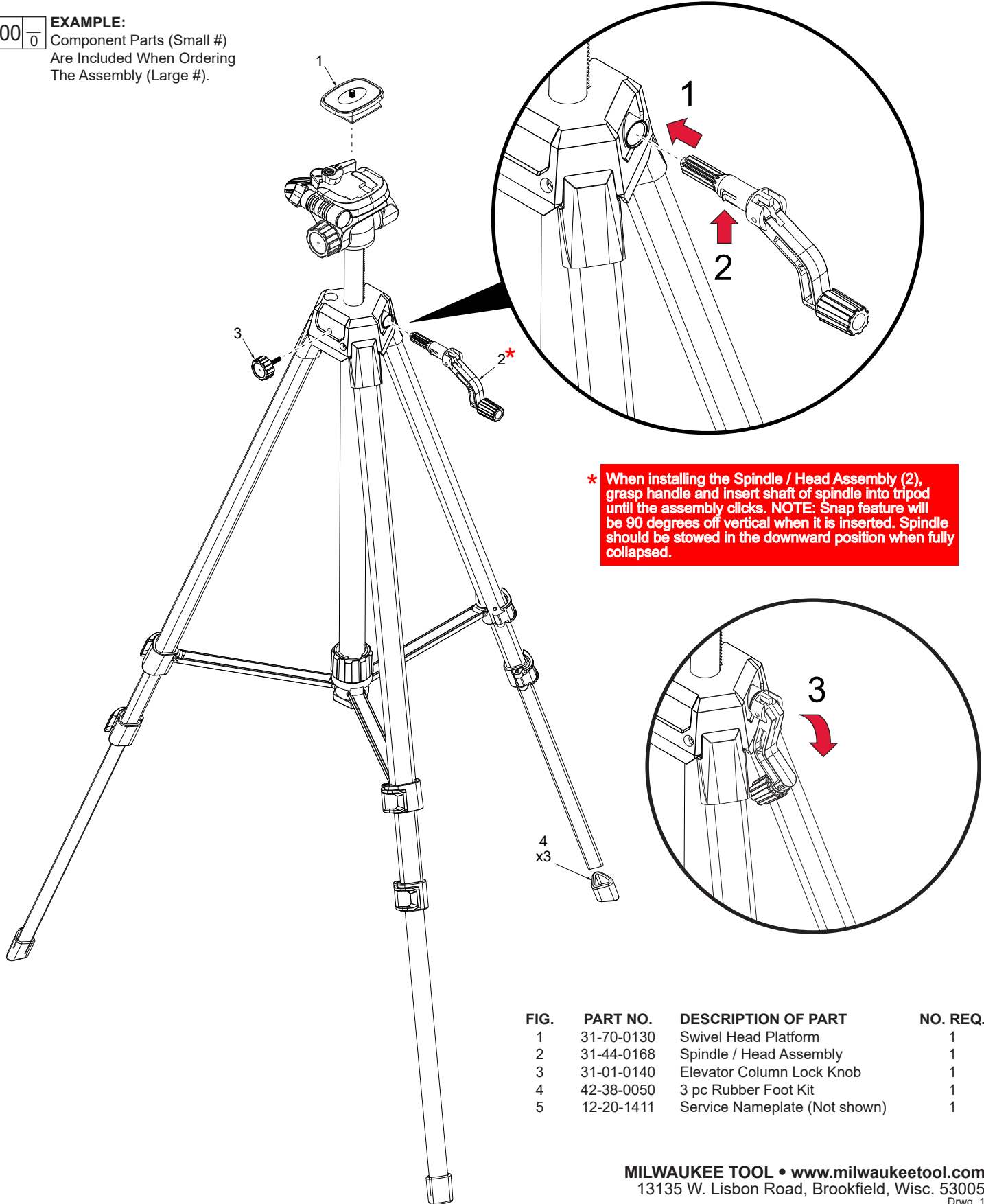

*** When installing the Spindle / Head Assembly (2), grasp handle and insert shaft of spindle into tripod until the assembly clicks. NOTE: Snap feature will be 90 degrees off vertical when it is inserted. Spindle should be stowed in the downward position when fully collapsed.**

FIG.	PART NO.	DESCRIPTION OF PART	NO. REQ.
1	31-70-0130	Swivel Head Platform	1
2	31-44-0168	Spindle / Head Assembly	1
3	31-01-0140	Elevator Column Lock Knob	1
4	42-38-0050	3 pc Rubber Foot Kit	1
5	12-20-1411	Service Nameplate (Not shown)	1