

High efficiency machining due to its optimized cutting edge geometry and highly rigid body

For a wide range of applications

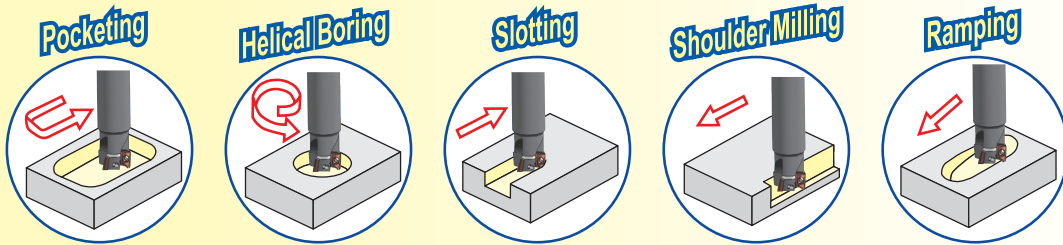

Tough, sharp and highly accurate cutting edge geometry

- The unique shape and strength of the cutting edge has been improved resulting in reduced cutting forces
- Insert facet generates high quality surface finishes

Wide selection of insert geometries and grades

- Available in 3 different geometries (L, G, and H)
- A wide range of machining applications due to the new "Super ZX" coating and CVD "Super FF" coating for steel and iron



Highly durable

- Cutter body and insert strength provide for high feed rate capabilities

Coolant holes

- Efficient chip removal due to new air/coolant hole design

Cutting Performance

- Shoulder accuracy generated in profile machining

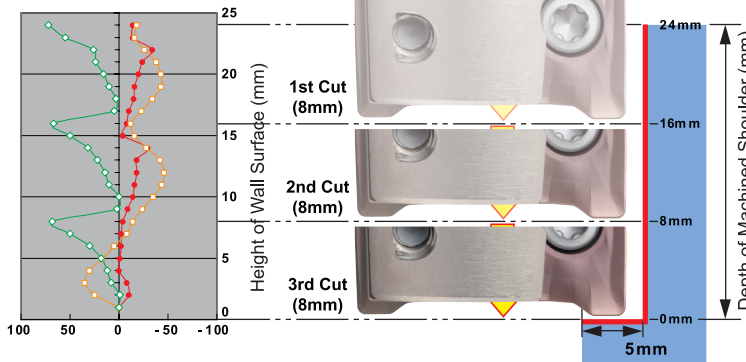
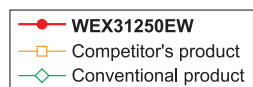

Minimal depth of cut variation due to assembly precision!



Indexable Milling
Shoulder Milling
Face Milling
High Feed Milling
Multi-purpose
Modular Tooling
UFO & SumiMill
Discontinued

Shoulder Milling Cutters

90° WaveMill Series Shoulder Mill

GRADE SELECTION GUIDE

WEX ENDMILLS

Work Material	P Steel K Cast Iron			M Stainless Steel S Heat-Resistant Alloy		N Aluminium Alloy
	L Type	G Type	H Type	Type	H Type	Type
Breaker						
Feature	Low Cutting Force	General Purpose	Strong Edge	General-Purpose Type For Exotic Alloys	Strong Edge Type For Exotic Alloys	High Rake Type
2000 Type Insert Figure	Not Available					
3000 Type Insert Figure						
Application	Light cut, low rigidity milling and reduce burrs	Main breaker General purpose to interrupted milling	Roughing, heavy interrupted and hardened steel milling	Light Cutting to General-Purpose	Heavy Interrupted Machining	Aluminium, Non-Ferrous Metal

Recommended Cutting Conditions

ISO	Material	Hardness	Grade	Depth of Cut			Feed per Tooth
				.002 - .050	.050 - .125	.125 & over	
P	Low and Medium Carbon Steels	<250 Bhn	ACP100	775-1310	725-1275	675-1225	.006-.0125
			ACP200	721-1213	675-1180	600-1125	.006-.0135
			ACP300	675-1075	650-1025	525-925	.006-.014
	Medium Carbon Alloy Steels	<250 Bhn	ACP100	600-975	575-950	550-900	.006-.0095
			ACP200	550-900	525-900	500-875	.006-.0115
			ACP300	525-875	500-825	475-800	.006-.0115
	Medium-High Carbon Steels	<250 Bhn	ACP100	600-975	575-950	550-900	.006-.011
			ACP200	575-950	550-925	500-875	.006-.012
			ACP300	575-950	550-925	500-875	.006-.012
	Free Machining Steels and Alloys	<250 Bhn	ACP100	725-1300	700-1250	675-1200	.006-.0135
			ACP200	750-1325	725-1275	675-1225	.006-.0135
			ACP300	675-1075	650-1050	650-1025	.006-.014
Tool Steels	<250 Bhn	ACP100	475-820	450-790	425-750	.0047-.010	
		ACP200	450-820	435-790	425-750	.0047-.011	
		ACP300	450-820	425-790	400-725	.0047-.012	
	bhn 220 - 350	ACP100	400-775	400-735	400-700	.004-.009	
		ACP200	425-750	400-725	375-690	.0045-.010	
		ACP300	420-700	420-695	375-685	.0047-.012	
>33 Hrc	ACP100	325-650	300-625	300-590	.003-.007		
	ACP200	325-650	300-625	300-590	.0045-.0095		
	ACP300	325-650	300-625	300-590	.0045-.0095		
M	Martensitic and Ferritic	<250 Bhn	ACM300	535-850	520-830	275-820	.004-.011
		>250 Bhn	ACM200	425-740	415-720	375-675	.004-.012
	Austenitic	<250 Bhn	ACM300	325-875	300-850	275-825	.004-.012
		<250 Bhn	ACM200	525-850	500-825	175-675	.004-.012
K	Grey Cast Iron	>250 Bhn	ACK200	700-1050	625-925	590-900	.004-.014
		>250 Bhn	ACK300	600-950	575-875	550-850	.004-.014
		<250 Bhn	ACK200	600-950	525-825	490-800	.004-.014
	Ductile Iron	>250 Bhn	ACK300	500-850	475-775	450-750	.004-.014
		>250 Bhn	ACK200	600-925	550-875	490-800	.004-.012
		>250 Bhn	ACK300	550-825	550-825	450-750	.004-.012
S	Exotic Alloys: Inconel, Hastalloy, Waspalloy, etc.	ACK200	100-160	70-150	60-135	.003-.0075	
		ACK300	100-160	70-150	60-135	.004-.0075	
N	Non-Ferrous Material	H1	1500-3800	1300-3700	1200-3600	.004-.014	
		DL1000	1500-4500	1475-4200	1275-4100	.004-.014	

Application Range

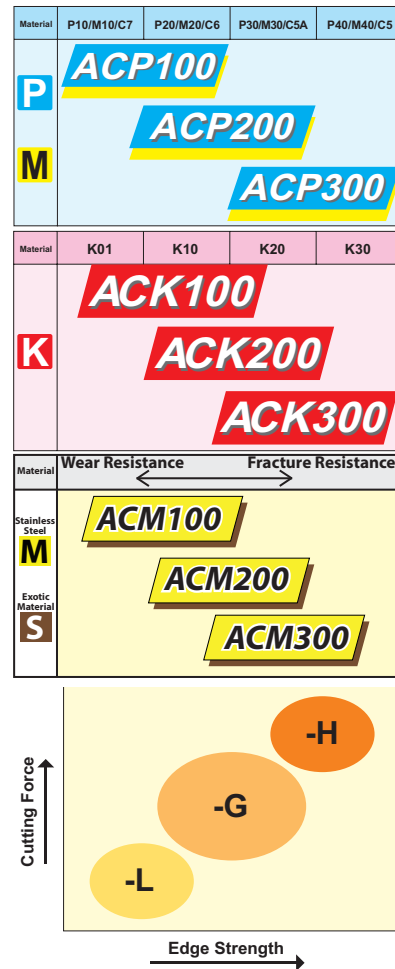

INCH

WEX 2000

APPLICABLE INSERT:

AXMT
AXET

METRIC

WEX 2000

APPLICABLE INSERT:

AXMT
AXET

■ Inch

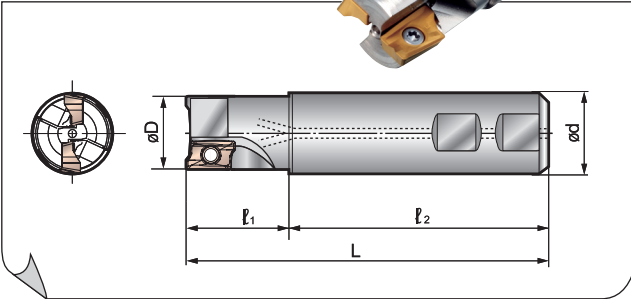

■ Metric

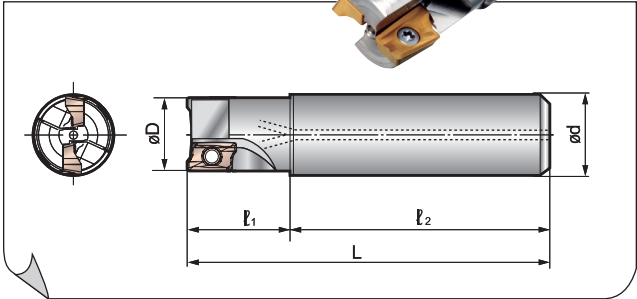

WEX 2000 Weldon Shank Series								
Catalog Number	Stock	Dimensions (inch)					Ramp Angle	Insert Qty.
		D	d	L	l ₁	l ₂		
WEX20500EW	•	0.500	0.750	3.325	1.309	2.031	5°	1
WEX20625EW	•	0.625	0.625	3.218	1.312	1.906	4°	2
WEX20625EMW	•	0.625	0.625	3.591	1.685	1.906	4°	2
WEX20750EW	•	0.750	0.750	3.561	1.530	2.031	4°	3
WEX20750EMW	•	0.750	0.750	4.091	2.060	2.031	4°	3
WEX20750ELW	•	0.750	0.750	5.091	3.060	2.031	4°	3
WEX21000EW	•	1.000	1.000	3.811	1.530	2.281	2°	4
WEX21250EW	•	1.250	1.250	4.531	2.250	2.281	1°30'	5

WEX 2000 Shank Series Standard type								
Catalog Number	Stock	Dimensions (mm)					Ramp Angle	Insert Qty.
		D	d	L	l ₁	l ₂		
WEX2014E	★	14	16	80	25	55	5°	1
WEX2016E	★	16	16	100	25	75	4°	2
WEX2018E	★	18	16	100	25	75	4°	2
WEX2020E	★	20	20	110	30	80	4°	3
WEX2022E	★	22	20	110	30	80	4°	3
WEX2025E	★	25	25	120	35	85	2°	4
WEX2028E	★	28	25	120	35	85	1°30'	4
WEX2030E	★	30	25	120	35	85	1°30'	4
WEX2032E	★	32	32	130	40	90	1°30'	5
WEX2040E	★	40	32	150	30	120	1°	6
WEX2050E	★	50	32	150	30	120	0°30'	7
WEX2063E	★	63	32	150	30	120	0°30'	8

• USA stocked item

WEX2000 Inserts

Max. Depth of Cut
AXMT12: 10mm (.394")
AXMT17: 14mm (.551")

Sumitomo Cat. No.	Dimensions (Inches)									
	P	K	M	S	N	L	W	T	R	Facet Width
AXMT123504PEERG	•	•	•	•	•	.472	.260	.138	.016	.061
AXMT123504PEERH	•	•	•	•	•	.472	.260	.138	.016	.061
AXMT123508PEERG	•	•	•	•	•	.472	.260	.138	.031	.061
AXMT123508PEERH	•	•	•	•	•	.472	.260	.138	.031	.061
AXMT123512PEERG	•	•	•	•	•	.472	.260	.138	.047	.061
AXMT123512PEERH	•	•	•	•	•	.472	.260	.138	.047	.061
AXMT123504PEERE				•	•	.472	.260	.138	.016	.061
AXMT123508PEERE				•	•	.472	.260	.138	.031	.061
AXMT123508PEEREH				•	•	.472	.260	.138	.031	.061
AXMT123512PEERE				•	•	.472	.260	.138	.047	.061
AXMT123516PEERE				•	•	.472	.260	.138	.063	.061
AXMT123524PEERE				•	•	.472	.260	.138	.094	.061
AXMT123532PEERE				•	•	.472	.260	.138	.126	.061
AXET123502PEFRS					•	.472	.260	.138	.047	.061
AXET123504PEFRS					•	.472	.260	.138	.016	.061
AXET123508PEFRS					•	.472	.260	.138	.031	.061

Sumitomo Cat. No. ACP100, ACP200, ACP300, ACK200, ACK300, ACP200, ACP300, DL1000, HI

* : insert radii expansion • USA stocked item

Coolant Through Bolts	
Catalog Number	Cutter Size
BFXH 3/8 x 1	2.00"
BFXH 1/2 x 1 1/4	2.50"
BFXH 1/2 x 1 1/4	3.00"
BFXH 5/8 x 1 1/4	4.00"
BFXH 3/4 x 1 1/2	5.00"

See pages ___ - ___
for recommended
running parameters

★ Worldwide Warehouse item

WEX 2000 Shank Series Long type								
Catalog Number	Stock	Dimensions (mm)					Ramp Angle	Insert Qty.
		D	d	L	l ₁	l ₂		
WEX2014EL	★	14	16	120	25	95	5°	1
WEX2016EL	•	16	16	145	25	120	4°	2
WEX2018EL	★	18	16	145	25	120	4°	2
WEX2020EL	★	20	20	150	40	110	4°	2
WEX2022EL	★	22	20	150	30	120	4°	2
WEX2025EL	★	25	25	170	50	120	2°	2
WEX2028EL	★	28	25	170	30	140	1°30'	2
WEX2030EL	★	30	25	170	30	140	1°30'	2
WEX2032EL	★	32	32	180	60	120	1°30'	2
WEX2040EL	★	40	32	180	30	150	1°	2

★ Worldwide Warehouse item

Hardware (Metric)		
Catalog Number	Insert Screw*	Insert Wrench
WEX2014-WEX2018	BFTX0305IP	TRDR08IP
WEX2020-WEX2063	BFTX0306IP	TRDR08IP

* Torque specifications for insert screw=18-22 in/lbs.

Hardware (Inch)		
Catalog Number	Insert Screw*	Insert Wrench
WEX20500-WEX20625	BFTX0305IP	TRDR08IP
WEX20750-WEX21250	BFTX0306IP	TRDR08IP

* Torque specifications for insert screw=18-22 in/lbs.



Weldon Shank Series



Shell Mill Series



INCH & METRIC

WEX 2000

APPLICABLE INSERT:

**AXMT
AXET**

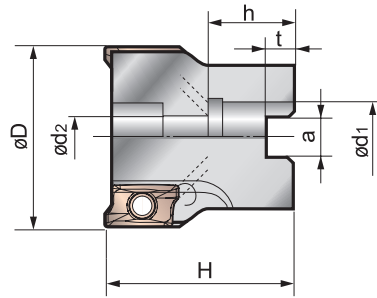

WEX 2000 Shell Mill Series (INCH)										
Catalog Number	Stock	Dimensions (Inches)							Ramp Angle	Insert Qty.
		D	d ₁	d ₂	a	t	H	h		
WEX21500R	•	1.500	0.750	0.406	0.312	0.187	1.562	0.750	2°	6
WEX22000R	•	2.000	0.750	0.406	0.312	0.187	1.562	0.750	1°	7
WEX22500R	•	2.500	1.000	0.531	0.375	0.218	1.562	0.750	0°30'	8

• USA stocked item

WEX 2000 Shell Mill Series (METRIC)										
Catalog Number	Stock	Dimensions (mm)							Ramp Angle	Insert Qty.
		D	d ₁	d ₂	a	t	H	h		
WEX2040F	★	40	16	9	8.4	5.6	40	18	2°	6
WEX2050F	★	50	22	11	10.4	6.3	40	20	1°	7
WEX2063F	★	63	22	11	10.4	6.3	40	20	0°30'	8

★ Worldwide Warehouse item

WEX2000 Inserts

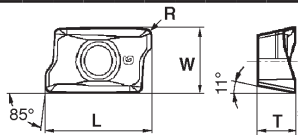

Max. Depth of Cut
AXMT12: 10mm (.394")
AXMT17: 14mm (.551")

Sumitomo Cat. No.	Material							Dimensions (Inches)				Facet Width
	P	K	M	S	N			L	W	T	R	
ACP100	•	•	•	•	•			.472	.260	.138	.016	.061
ACP200	•	•	•	•	•			.472	.260	.138	.016	.061
ACP300	•	•	•	•	•			.472	.260	.138	.031	.061
ACK200	•	•	•	•	•			.472	.260	.138	.031	.061
ACK300	•	•	•	•	•			.472	.260	.138	.047	.061
ACM200						•	•	.472	.260	.138	.016	.061
ACM300						•	•	.472	.260	.138	.031	.061
DL1000								.472	.260	.138	.047	.061
H1								.472	.260	.138	.094	.061
AXMT123504PEERG								.472	.260	.138	.126	.061
AXMT123504PEERH								.472	.260	.138	.016	.061
AXMT123508PEERG								.472	.260	.138	.031	.061
AXMT123508PEERH								.472	.260	.138	.031	.061
AXMT123512PEERG								.472	.260	.138	.047	.061
AXMT123512PEERH								.472	.260	.138	.047	.061
AXMT123504PEERE								.472	.260	.138	.016	.061
AXMT123508PEERE								.472	.260	.138	.031	.061
AXMT123508PEEREH								.472	.260	.138	.031	.061
AXMT123512PEERE								.472	.260	.138	.047	.061
AXMT123516PEERE								.472	.260	.138	.063	.061
AXMT123524PEERE								.472	.260	.138	.094	.061
AXMT123532PEERE								.472	.260	.138	.126	.061
AXET123502PEFRS								.472	.260	.138	.047	.061
AXET123504PEFRS								.472	.260	.138	.016	.061
AXET123508PEFRS								.472	.260	.138	.031	.061

* : insert radii expansion • USA stocked item

Hardware (Inch)

Catalog Number	Insert Screw*	Insert Wrench
WEX21500-WEX22500	BFTX0306IP	TRDR08IP

* Torque specifications for insert screw=18-22 in/lbs.

Hardware (Metric)

Catalog Number	Insert Screw*	Insert Wrench
WEX2040-WEX2063	BFTX0306IP	TRDR08IP

* Torque specifications for insert screw=18-22 in/lbs.

Coolant Through Bolts

Catalog Number	Cutter Size
BFXH 3/8 x 1	2.00"
BFXH 1/2 x 1 1/4	2.50"
BFXH 1/2 x 1 1/4	3.00"
BFXH 5/8 x 1 1/4	4.00"
BFXH 3/4 x 1 1/2	5.00"

See pages ___ - ___
for recommended
running parameters



Indexable Milling

Shoulder Milling

Face Milling

High Feed Milling

Multi-purpose

Modular Tooling

UFO & SumiMill

Discontinued

INCH

APPLICABLE INSERT:

WEX 3000

AXMT
AXET

■ Inch

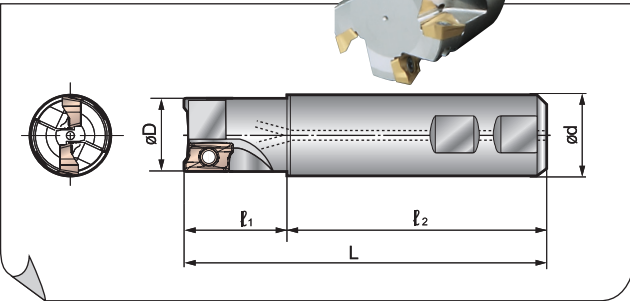

WEX 3000 Weldon Shank Series

Catalog Number	Stock	Dimensions (inch)					Ramp Angle	Insert Qty.
		D	d	L	ℓ ₁	ℓ ₂		
WEX31000EW	•	1.000	1.000	3.811	1.530	2.281	5°	2
WEX31000EMW	•	1.000	1.000	4.841	2.560	2.281	5°	2
WEX31000ELW	•	1.000	1.000	6.341	4.060	2.281	5°	2
WEX31250EW	•	1.250	1.250	4.531	2.250	2.281	3°	3
WEX31250EMW	•	1.250	1.250	6.381	4.100	2.281	3°	3
WEX31500EW	•	1.500	1.250	4.531	2.250	2.281	2°	4
WEX32000EW	•	2.000	1.250	4.531	2.250	2.281	2°	5

• USA stocked item

WEX3000 Inserts

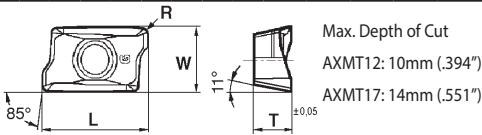
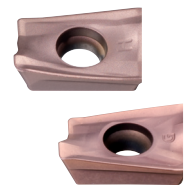

Max. Depth of Cut
AXMT12: 10mm (.394")
AXMT17: 14mm (.551")

Sumitomo Cat. No.	Dimensions (Inches)									
	P	K	M	S	N	L	W	T	R	Facet Width
ACP100	•	•	•	•	•					
ACP200	•	•	•	•	•					
ACP300	•	•	•	•	•					
ACK200	•	•	•	•	•					
ACK300	•	•	•	•	•					
ACM200			•	•	•					
ACM300			•	•	•					
DL1000										
H1										
AXMT170504PEERG	•	•	•	•	•	.689	.402	.219	.016	.118
AXMT170508PEERG	•	•	•	•	•	.689	.402	.219	.031	.118
AXMT170508PEERH	•	•	•	•	•	.689	.402	.219	.031	.118
AXMT170508PEERL	•	•	•	•	•	.689	.402	.219	.031	.118
AXMT170512PEERG	•	•	•	•	•	.689	.402	.219	.047	.118
AXMT170512PEERH	•	•	•	•	•	.689	.402	.219	.047	.118
AXMT170516PEERG	•	•	•	•	•	.689	.402	.219	.063	.118
AXMT170520PEERG	•	•	•	•	•	.689	.402	.219	.079	.118
AXMT170530PEERG	•	•	•	•	•	.689	.402	.219	.118	.118
AXMT170532PEERG	•	•	•	•	•	.689	.402	.219	.126	.118
AXMT170504PEERE				•	•	.689	.402	.219	.016	.118
AXMT170508PEERE				•	•	.689	.402	.219	.031	.118
AXMT170508PEEREH				•	•	.689	.402	.219	.031	.118
AXET170512PEERE				•	•	.689	.402	.219	.047	.118
AXET170516PEERE				•	•	.689	.402	.219	.063	.118
AXET170520PEERE				•	•	.689	.402	.219	.079	.118
* AXET170524PEERE				•	•	.689	.402	.219	.094	.118
* AXET170530PEERE				•	•	.689	.402	.219	.118	.118
* AXET170531PEERE				•	•	.689	.402	.219	.122	.118
* AXET170548PEERE				•	•	.689	.402	.219	.189	.118
* AXET170563PEERE				•	•	.689	.402	.219	.248	.118
AXET170502PEFRS					•	.689	.402	.219	.008	.118
AXET170504PEFRS					•	.689	.402	.219	.016	.118
AXET170508PEFRS					•	.689	.402	.219	.031	.118

* : insert radii expansion

• USA stocked item

Hardware (Inch)

Catalog Number	Insert Screw*	Insert Wrench
WEX31000	BFTX0407IP	TRDR15IP
WEX31250-WEX32000	BFTX0409IP	TRDR15IP

* Torque specifications for insert screw=27-31 in/lbs.

METRIC

APPLICABLE INSERT:

WEX 3000

AXMT
AXET

■ Metric

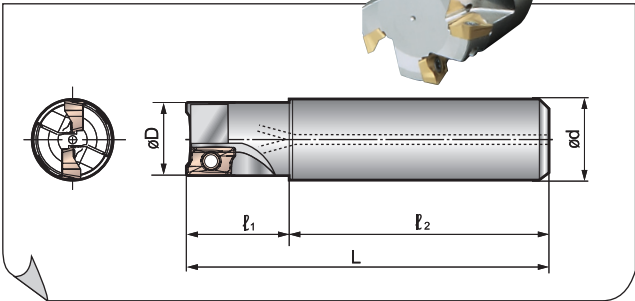

WEX 3000 Shank Series Standard Type

Catalog Number	Stock	Dimensions (mm)					Ramp Angle	Insert Qty.
		D	d	L	ℓ ₁	ℓ ₂		
WEX3025E	★	25	25	120	35	85	5°	2
WEX3032E	★	32	32	130	40	90	3°	3
WEX3040E	★	40	32	170	50	120	2°	4
WEX3050E	★	50	32	170	50	120	1°	5
WEX3063E	★	63	32	170	50	120	0°30'	6

★ Worldwide Warehouse item

WEX 3000 Shank Series Short Type

Catalog Number	Stock	Dimensions (mm)					Ramp Angle	Insert Qty.
		D	d	L	ℓ ₁	ℓ ₂		
WEX3050ES	★	50	32	135	25	110	1°	5
WEX3063ES	★	63	32	135	25	110	0°30'	6

★ Worldwide Warehouse item

WEX 3000 Shank Series Long Type

Catalog Number	Stock	Dimensions (mm)					Ramp Angle	Insert Qty.
		D	d	L	ℓ ₁	ℓ ₂		
WEX3025EL	★	25	25	170	50	120	5°	2
WEX3028EL	★	28	25	170	50	120	5°	2
WEX3030EL	★	30	25	180	60	120	5°	2
WEX3032EL	★	32	32	180	60	120	3°	2
WEX3035EL	★	35	32	180	60	120	2°	2
WEX3040EL	★	40	32	220	80	140	2°	2

★ Worldwide Warehouse item

WEX 3000 Shank Series Coarse Pitch Type

Catalog Number	Stock	Dimensions (mm)					Ramp Angle	Insert Qty.
		D	d	L	ℓ ₁	ℓ ₂		
WEX3040E-C	★	40	32	170	50	120	2°	3
WEX3050E-C	★	50	32	170	50	120	1°	3
WEX3063E-C	★	63	32	170	50	120	0°30'	4

★ Worldwide Warehouse item

WEX 3000 Shank Series Short & Coarse Pitch Type

Catalog Number	Stock	Dimensions (mm)					Ramp Angle	Insert Qty.
		D	d	L	ℓ ₁	ℓ ₂		
WEX3050ES-C	★	50	32	135	25	110	1°	3
WEX3063ES-C	★	63	32	135	25	110	0°30'	4

★ Worldwide Warehouse item

Hardware (Metric)

Catalog Number	Insert Screw*	Insert Wrench
WEX3025	BFTX0407IP	TRDR15IP
WEX3032-WEX3063	BFTX0409IP	TRDR15IP

See pgs. 301, 302, or 304 for coolant bolt avail.

* Torque specifications for insert screw=27-31 in/lbs.



Indexable Milling
Shoulder Milling
Face Milling
High Feed Milling
Multi-purpose
Modular Tooling
UFO & SumiMill
Discontinued

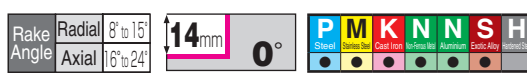

WEX 3000 Shell Mill Series (Inch)

Catalog Number	Stock	Dimensions (Inches)							Ramp Angle	Insert Qty.	Fig.
		D	d ₁	d ₂	a	t	H	h			
WEX32000R	•	2.000	0.750	0.406	0.312	0.187	1.562	0.750	1°	5	1
WEX32500R	•	2.500	1.000	0.531	0.375	0.218	1.562	0.750	0°30'	6	1
WEXC33000R	•	3.000	1.000	0.531	0.375	0.218	1.750	0.750	0°30'	5	1
WEX33000R	•	3.000	1.000	0.531	0.375	0.218	1.750	0.750	0°30'	7	1
WEXC34000R	•	4.000	1.250	0.656	0.500	0.281	2.000	0.750	N/A	6	1
WEXC34000R-1.50	•	4.000	1.500	0.781	0.626	0.380	2.461	1.535	N/A	6	1
WEX34000R	•	4.000	1.250	0.656	0.500	0.281	2.000	0.750	N/A	8	1
WEX34000R-150	•	4.000	1.500	0.781	0.626	0.380	2.461	1.535	N/A	8	1
WEXC36000R	•	6.000	1.500	1.500	0.625	0.380	2.500	1.060	N/A	8	1
WEX38000R	•	8.000	2.500	2.500	1.000	0.560	2.500	1.250	N/A	12	2

• USA stocked item

WEX 3000 Shell Mill Series Standard Type (Metric)

Catalog Number	Stock	Dimensions (mm)							Ramp Angle	Insert Qty.
		D	d ₁	d ₂	a	t	H	h		
WEX3040F	★	40	16	9	8.4	5.6	40	18	2°	4
WEX3050F	★	50	22	11	10.4	6.3	40	20	1°	5
WEX3063F	★	63	22	11	10.4	6.3	40	20	0°30'	6
WEX3080R	★	80	25.40	13	9.5	6	50	25	0°30'	4
WEX3100R	★	100	31.75	-	12.7	8	63	-	N/A	5
WEX3125R	★	125	38.10	-	15.9	10	63	-	N/A	6

★ Worldwide Warehouse item

WEX 3000 Shell Mill Series Fine Pitch Type (Metric)

Catalog Number	Stock	Dimensions (mm)							Ramp Angle	Insert Qty.
		D	d ₁	d ₂	a	t	H	h		
WEXF3080R	★	80	25.40	13	9.5	6	50	25	0°30'	7
WEXF3100R	★	100	31.75	-	12.7	8	63	-	N/A	8
WEXF3125R	★	125	38.10	-	15.9	10	63	-	N/A	9

★ Worldwide Warehouse item

WEX3000 Inserts

Max. Depth of Cut
AXMT12: 10mm (.394")
AXMT17: 14mm (.551")

Sumitomo Cat. No.	Material						Dimensions (Inches)					
	P	K	M	S	N		L	W	T	R	Facet Width	
	ACP100	ACP200	ACP300	ACK200	ACK300	ACM200	ACM300	DL1000	H1			
AXMT170504PEERG	•	•	•	•	•		.689	.402	.219	.016	.118	
AXMT170508PEERG	•	•	•	•	•		.689	.402	.219	.031	.118	
AXMT170508PEERH	•	•	•	•	•		.689	.402	.219	.031	.118	
AXMT170508PEERL	•	•	•	•	•		.689	.402	.219	.031	.118	
AXMT170512PEERG	•	•	•	•	•		.689	.402	.219	.047	.118	
AXMT170512PEERH	•	•	•	•	•		.689	.402	.219	.047	.118	
AXMT170516PEERG	•	•	•	•	•		.689	.402	.219	.063	.118	
AXMT170520PEERG	•	•	•	•	•		.689	.402	.219	.079	.118	
AXMT170530PEERG	•	•	•	•	•		.689	.402	.219	.118	.118	
AXMT170532PEERG	•	•	•	•	•		.689	.402	.219	.126	.118	
AXMT170504PEERE					•	•	.689	.402	.219	.016	.118	
AXMT170508PEERE					•	•	.689	.402	.219	.031	.118	
AXMT170508PEEREH					•	•	.689	.402	.219	.031	.118	
AXET170512PEERE					•	•	.689	.402	.219	.047	.118	
AXET170516PEERE					•	•	.689	.402	.219	.063	.118	
AXET170520PEERE					•	•	.689	.402	.219	.079	.118	
AXET170524PEERE					•	•	.689	.402	.219	.094	.118	
AXET170530PEERE					•	•	.689	.402	.219	.118	.118	
AXET170531PEERE					•	•	.689	.402	.219	.122	.118	
AXET170548PEERE					•	•	.689	.402	.219	.189	.118	
AXET170563PEERE					•	•	.689	.402	.219	.248	.118	
AXET170502PEFRS						•	.689	.402	.219	.008	.118	
AXET170504PEFRS						•	.689	.402	.219	.016	.118	
AXET170508PEFRS						•	.689	.402	.219	.031	.118	

* : insert radii expansion

• USA stocked item

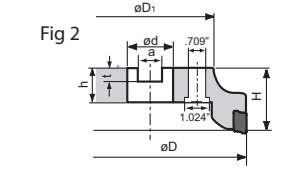
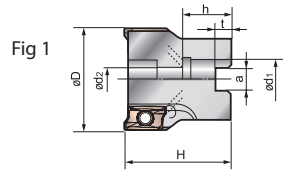

Indexable Milling
 Shoulder Milling
 Face Milling
 High Feed Milling
 Multi-purpose
 Modular Tooling
 UFO & SumiMil
 Discontinued

Hardware (Inch)		
Catalog Number	Insert Screw*	Insert Wrench
WEX32000-WEX34000	BFTX0409IP	TRDR15IP

* Torque specifications for insert screw=27-31 in./lbs.

Hardware (Metric)		
Catalog Number	Insert Screw*	Insert Wrench
WEX3040-WEX3125	BFTX0409IP	TRDR15IP

* Torque specifications for insert screw=27-31 in./lbs.

Coolant Through Bolts	
Catalog Number	Cutter Size
BFXH 3/8 x 1	2.00"
BFXH 1/2 x 1 1/4	2.50"
BFXH 1/2 x 1 1/4	3.00"
BFXH 5/8 x 1 1/4	4.00"
BFXH 3/4 x 1 1/2	5.00"

