

STRIP CURTAINS



Steiner tinted welding strip curtains filter most ultraviolet radiation, while allowing useful visible light into the area. Used for welding applications to enclose workstations or machinery

Clear strip curtains are used in loading docks, warehouses, walk-in freezers, and clean rooms, offering excellent optical clarity

- Flame retardant; meets California Fire Marshal requirements
- Barrier for dust, smoke, and flying debris
- Reduces noise and energy cost
- Highly transparent and allows natural light in dark areas
- Provides easy access of walk-through traffic or movement of equipment into the area.

GENERAL GUIDELINES

Overlap/width

- Partial overlap is used for light to medium personnel traffic. 8" wide strips with 1/2 overlap is recommended
- For medium/heavy personnel traffic. 12" wide strip with 2/3 overlap is recommended
- Full overlap is used for vehicle or heavy personnel traffic. 12" or 16" wide strip with full overlap is recommended

Height

- Not recommended to use 8" wide strips for height over 8'

Opening size to load height ratio

- If the opening is small in relation to the size of the load being moved, consider smaller width strips with less overlap as the strips are more prone to dragging over the load

HOW TO ORDER

- 1 Determine width of the strips and overlap
- 2 Determine the mounting method, then select mounting hardware
- 3 Measure height and width of your door, opening, or area to enclose
- 4 Select the clear or tinted color desired
- 5 Select the part number from the table - choosing by area (including overlap), length or a full roll
- 6 Order strip mounting hardware separately

Sold By	8" Wide/ .080" Thick				12" Wide/ .120" Thick			16" Wide/ .160" Thick
	AMBER	ORANGE	BLUE	CLEAR	AMBER	ORANGE	CLEAR	CLEAR
Area (sq ft) - 1/2 overlap	73485	73885	73585	73985	-	-	-	73965
Area (sq ft) - 2/3 overlap	-	-	-	-	73427	73827	73927	-
Area (sq ft) - Full overlap	73480	73880	73580	73980	73420	73820	73920	73960
Cut length (ft)	73408	73808	73508	73908	73412	73812	73912	73916
300' Roll	63408	63808	63508	63908	-	-	-	-
200' Roll	-	-	-	-	63412	-	63912	-
150' Roll	-	-	-	-	-	63812	-	-
100' Roll	-	-	-	-	-	-	-	63916

WARNING: Tinted transparent strips are not intended as a substitute for normal eye protection for close or long-term viewing. The user must wear protective eyewear suitable for the application. Clear transparent strips are not recommended for welding.

STRIP CURTAINS HARDWARE

UNIVERSAL MOUNT

Steiner's Universal Mount is made of 16-gauge galvanized steel. Permanent 1/4" threaded studs on 2" centers allow the pre-punched strips to be mounted to horizontal or vertical surfaces easily and quickly

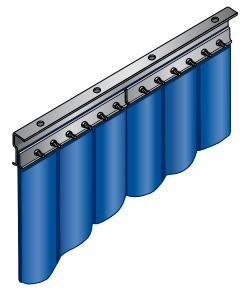

Length	3 ft	4 ft	5 ft	6 ft	8 ft
Item No.	47403	47404	47405	47406	47408

Universal Mount - mounting methods

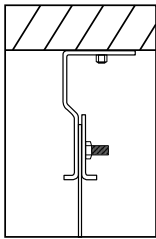

Header Mount
Attaches to the lintel of inside doorway. Order strips 1-1/2" shorter to accommodate hardware

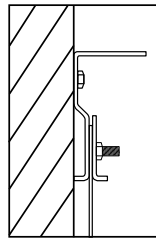

Wall Mount
Attaches to wall surface over doorway (above door jamb)

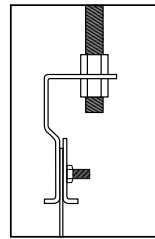

Threaded Rod
Suspends by clamp and 1/2" rod from overhead beam

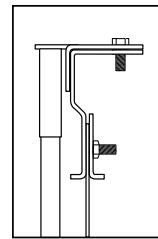

Floor Mount
Utilizes upright floor columns up to 10' high. (and 44367 bracket)

PIPE MOUNT

Steiner's unique Pipe Mount system allows easy mounting of strip curtains to an overhead pipe

- Pipe Mount system fits up to 2" diameter pipe
- Requires 3 clamps per linear foot
- Each pipe clamp is 4" wide and holds 2 strips (overlapped)
- Hardware includes 1 precurved hang clamp, 1 precurved cover clamp and 2 locknuts

Length	4"
Item No.	47301

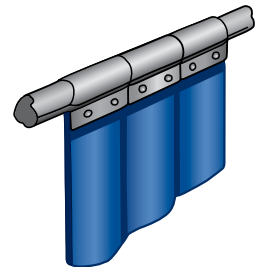

ADJUST-A-WALL™ STRIP TROLLEY

Adjust-A-Wall™ Trolleys allow vinyl strip curtains to be installed on curtain wall partition systems to allow the strip curtains to slide out of the way and then back. Straight trolleys are available in 18", 24", and 36". Hinged trolleys come in three 4" segments and can be combined

Straight Rolling Trolley

Nylon wheels roll along straight track. Consecutive trolleys can be linked together. (See Adjust-A-Wall™ hardware pages 60-61)

Length	18"	24"	36"
Item No.	44606	44607	44608

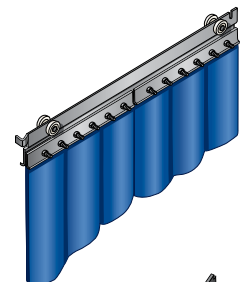

Hinged Trolley

Wheels roll through curved or straight track. Three 4" segments hinged together to allow rolling on curved track

Length	12"
Item No.	44610

